

Interdisciplinary Studio Pavilion (ISP) 2019

Creating a pavilion for SLO County's Wine History Project

This competition consisted of 8 team of architects, structural engineers, and construction management majors to create a pavilion to showcase artifacts for the Wine History Project. The pavilion is intended to be placed at different wineries throughout San Luis Obispo county to showcase the history of the SLO County's wine community. Factors to consider when designing the pavilion were; being able to transport it in a Uhaul, being able to assemble it onsite with no heavy equipment (just ladders and people), and designing it be be stable without having any foundation.

Product	Procurement	Quantity	Price Per	Price
4'x8'x1/8" White Acrylic Sheet	Tapplastic	1	\$ 129.00	\$ 129.00
2"x2"x.125" Steel Square Tubing (20' Length)	B&B Steel	2	\$ 53.00	\$ 106.00
1/8" Steel solid round (12' Length)	B&B Steel	5	\$ 3.00	\$ 15.00
1/8"x2" Steel Flat (20' Length)	B&B Steel	1	\$ 15.25	\$ 15.25
1" Sheet metal screws, selftapping, phillips pan head, Stainless steel 18-8 painted head (white), #8 (Product # 10529)	Bolt Depot	100 pack	\$ 10.20	\$ 10.20
Structural bolts A325, Steel Plain finish, 5/8"-11 (5") (product #21455)	Bolt Depot	2	\$ 1.71	\$ 3.42
Structural nuts A194 grade 2H, Steel Plain finish 5/8"-11 (Product #21580)	Bolt Depot	2	\$ 0.37	\$ 0.74
Structural washers F436, Steel plain finish, 5/8" (product #21617)	Bolt Depot	2	\$ 0.17	\$ 0.34
Spectrum Transparent Dichroic film (4ft wide)	Decorative films	4 running feet	\$15.85	\$ 63.40
Weld-On 4 Acrylic Adhesive - 4 Oz and Weld-on Applicator Bottle with Needle	Amazon	1	\$ 18.20	\$ 18.20
			Total Price	\$ 361.55

Procurement for our full scale detail model. We had to get pricing under a budget of 400\$. A lot of value engineering went into this!

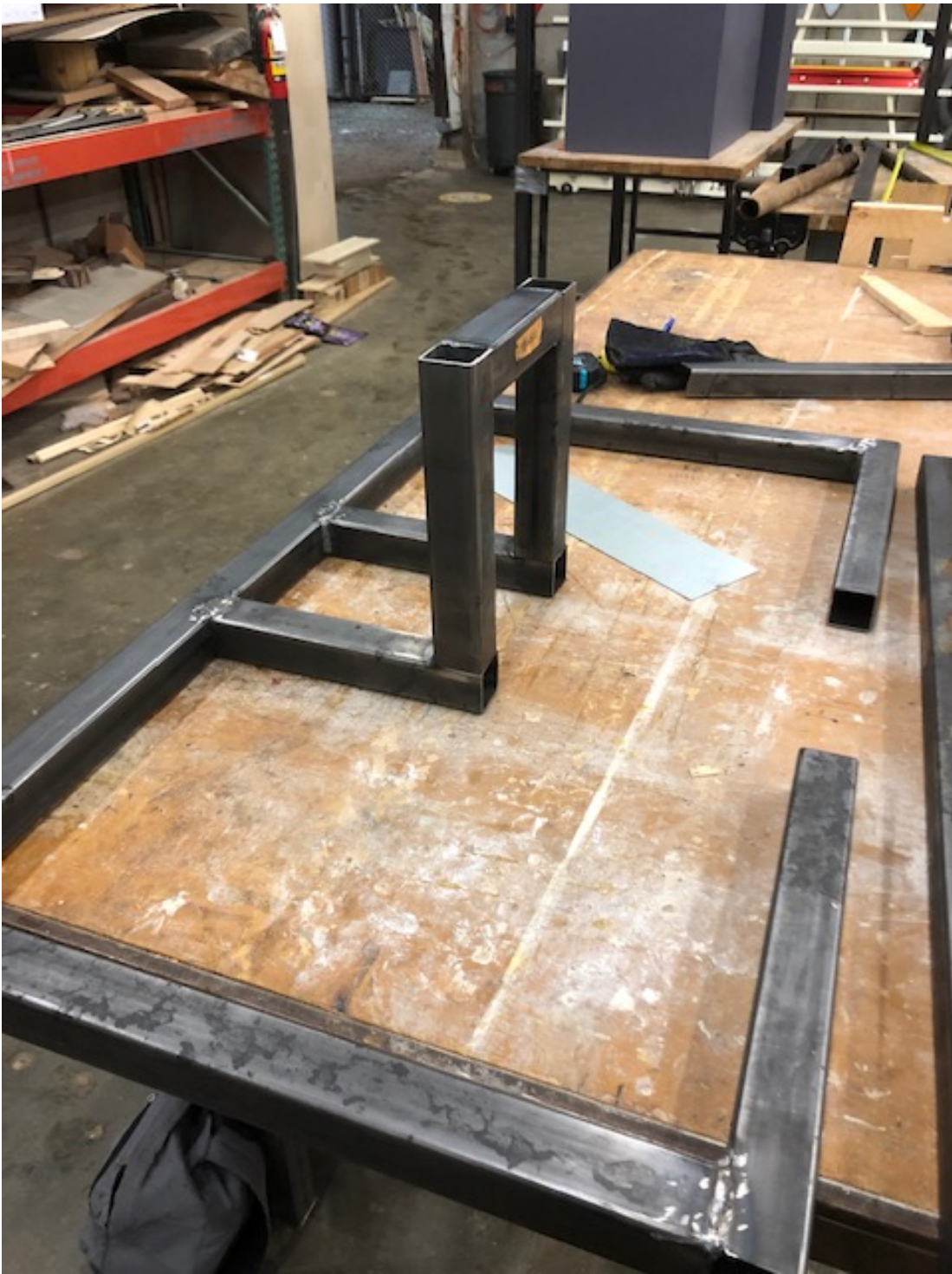

A current look at our full scale model. Through this I got to teach myself how to weld.

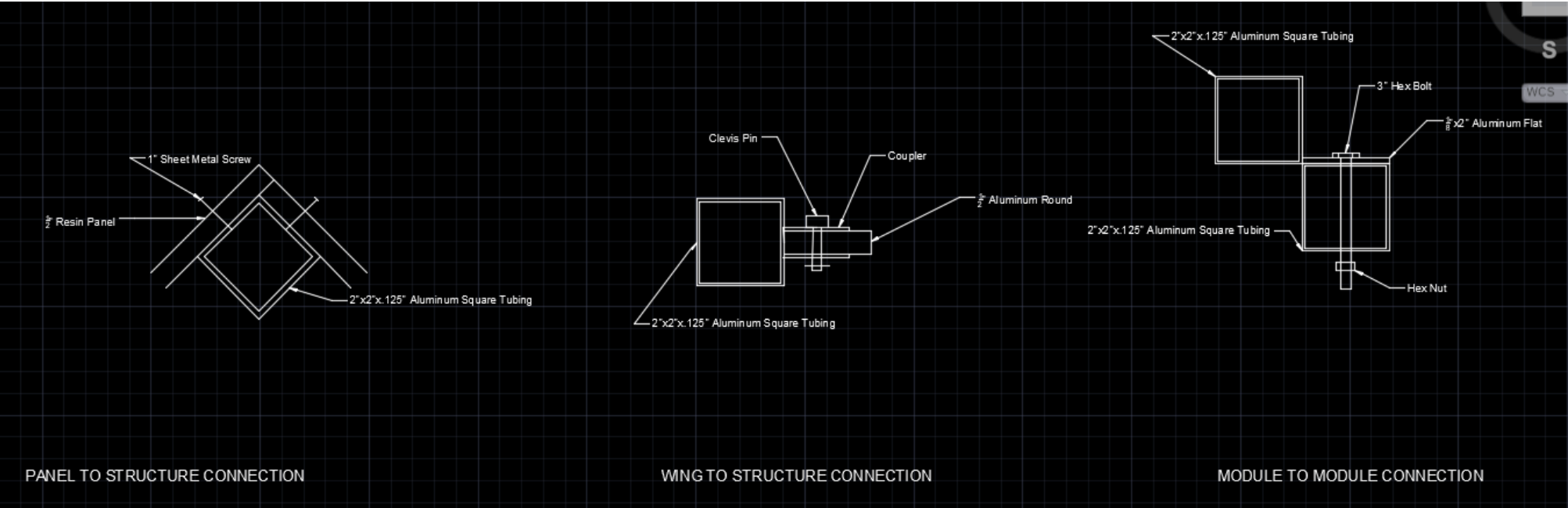

Connection details for connecting the modules to one another.

Key Words: Interdisciplinary, Collaborative, IPD, Pavilion

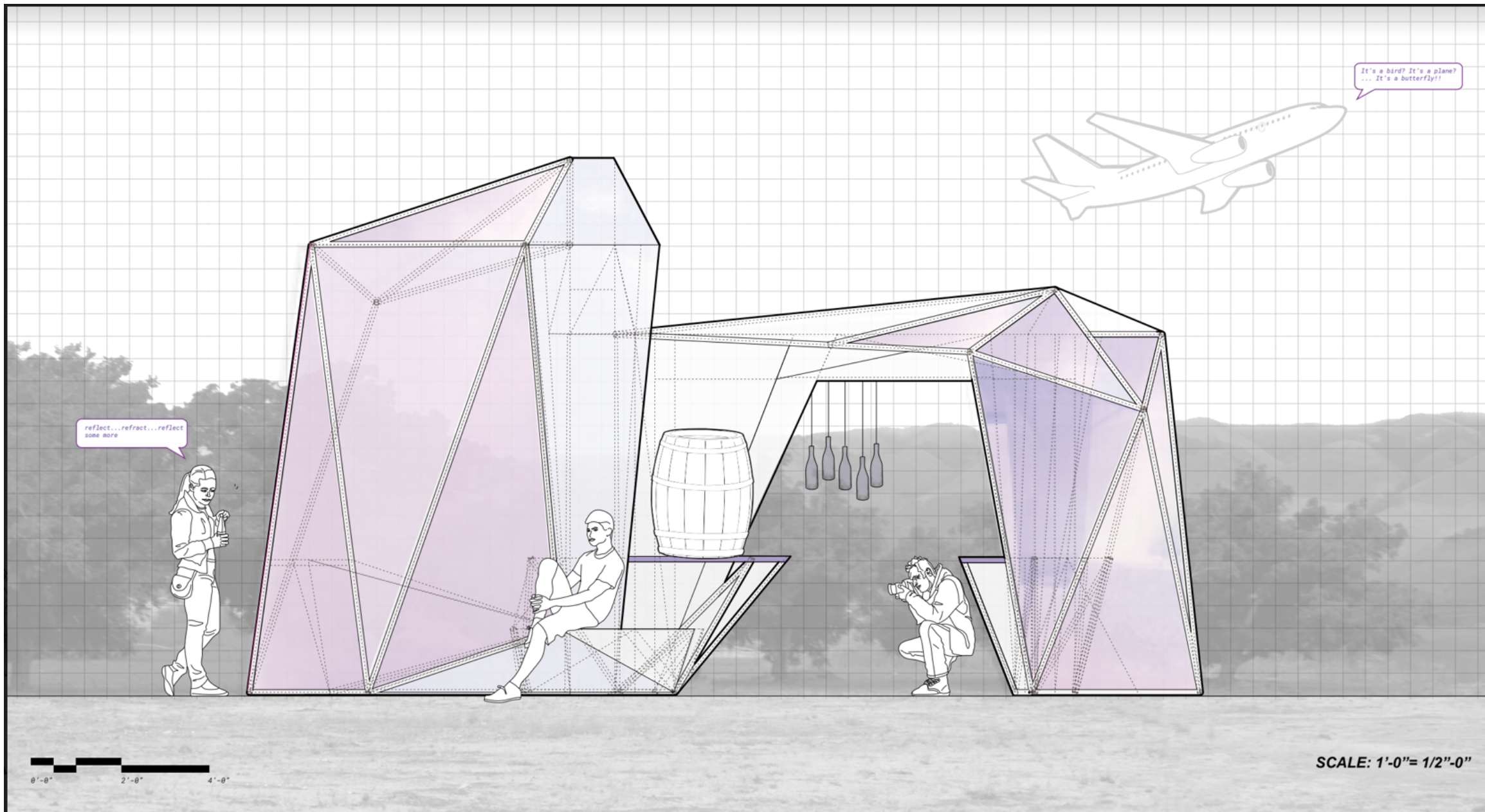

A rendering of what our design would look like at Saucelito Canyon Winery

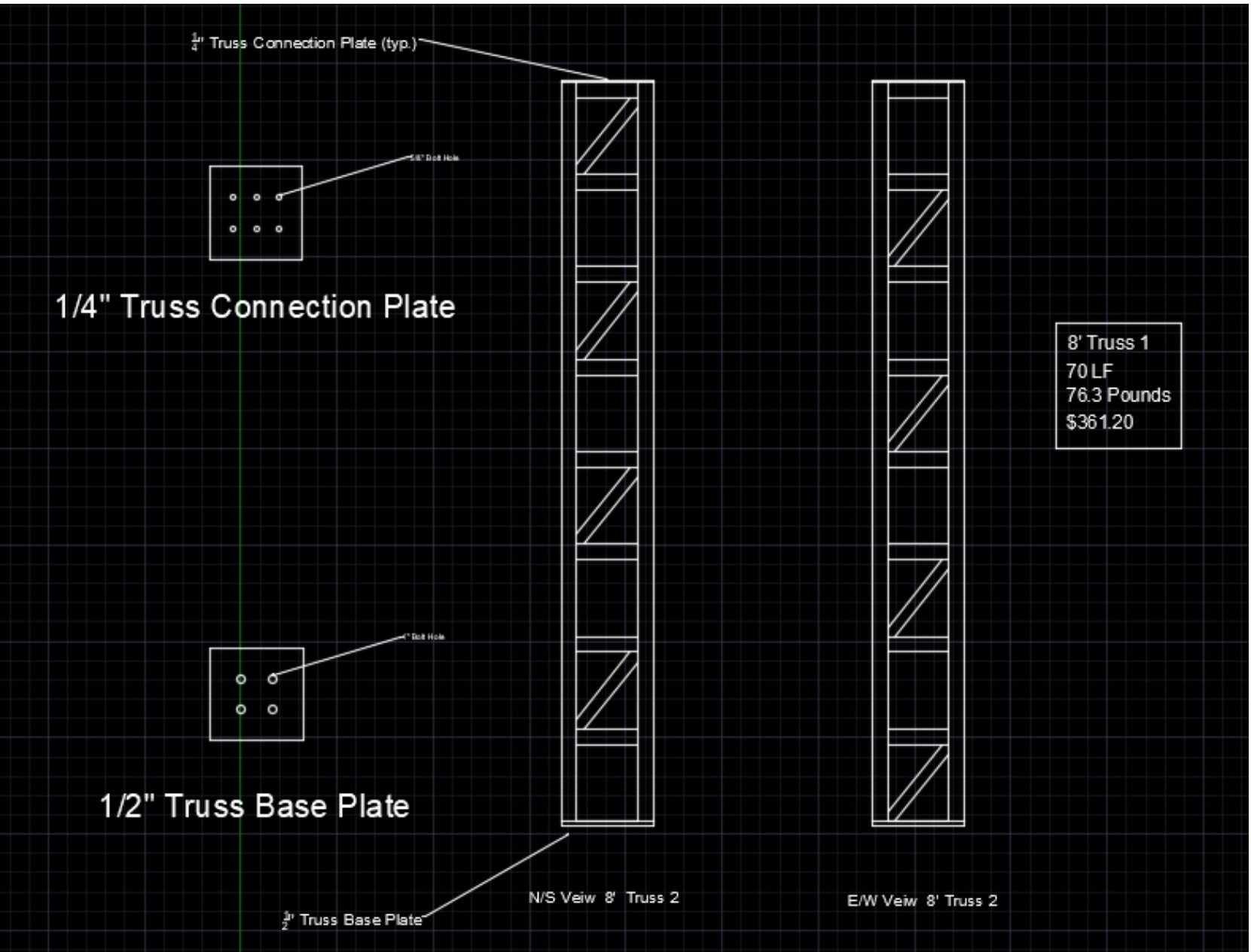

Our final deliverables include a fabrication binder and an assembly binder.