



# SENIOR PROJECT TEAM 45 DRAWING PACKET

JOSHUA CLEMENS  
KELLEN FUJISHIN  
ALYSSON LOO  
SAMARA VAN BLARICOM

ADVISOR: LEE MCFARLAND

SPONSORS: CHRISTIAN STRAULI,  
JENNIFER CROOKS

MECHANICAL ENGINEERING DEPARTMENT

CALIFORNIA POLYTECHNIC STATE UNIVERSITY,  
SAN LUIS OBISPO

FALL 2020

## Drawing Numbers

<b>Full Assembly .....</b>	<b>1</b>
<b>Full Assembly (Exploded) .....</b>	<b>2</b>
<b>Vertical Motion Subassembly .....</b>	<b>3</b>
<b>Vertical Motion Subassembly (Exploded) .....</b>	<b>4</b>
<b>Horizontal Motion Subassembly .....</b>	<b>5</b>
<b>Horizontal Motion Subassembly (Exploded) .....</b>	<b>6</b>
<b>Frame Subassembly .....</b>	<b>7</b>
<b>Frame Subassembly (Exploded) .....</b>	<b>8</b>
<b>Vertical Platform Subassembly (Exploded) .....</b>	<b>9</b>
<b>Vertical Platform Components .....</b>	<b>10-12</b>
<b>Horizontal Platform Subassembly (Exploded) .....</b>	<b>13</b>
<b>Horizontal Platform Components .....</b>	<b>14</b>
<b>508 Frame Case Panels .....</b>	<b>15</b>
<b>Vertical Platform Subassembly (Exploded) .....</b>	<b>16</b>
<b>Original Main Cam .....</b>	<b>17</b>
<b>Revised Main Cam Profile .....</b>	<b>17A</b>
<b>Purchased Part Drawings</b>	

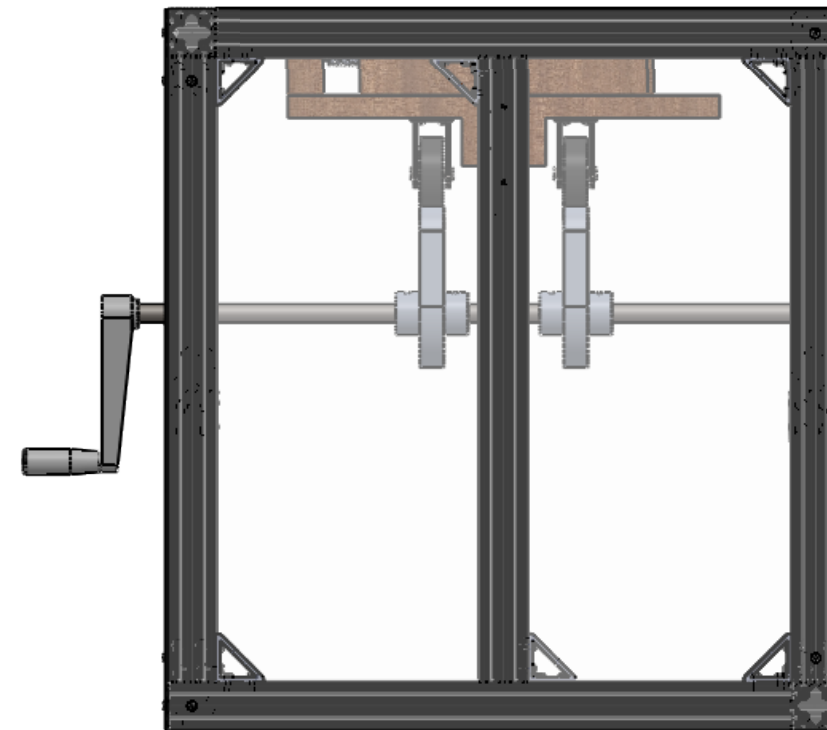
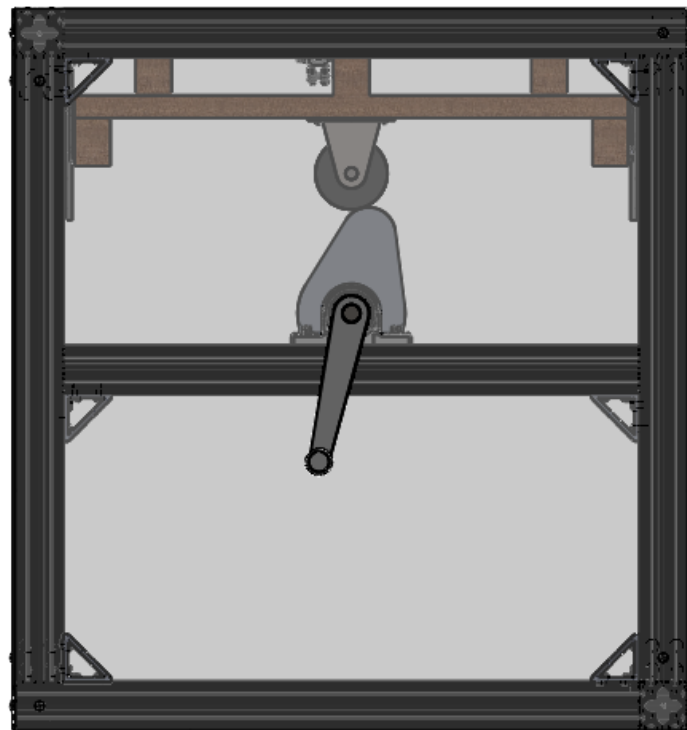
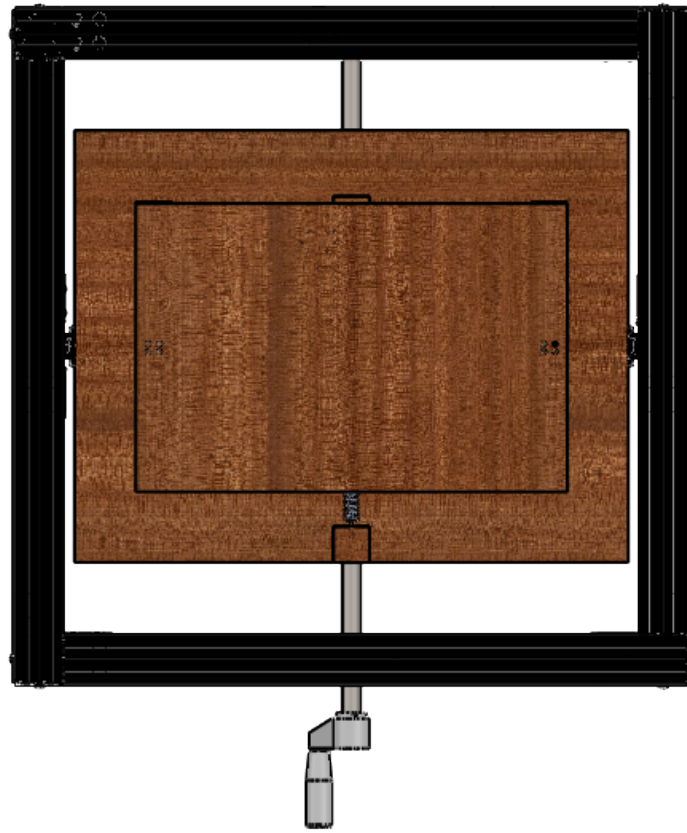

Cal Poly Mechanical Engineering ME 429 - SPR 2020	Lab Section: 03	SP DRAWINGS	Title: FULL SHAKE TABLE ASSEMBLY		Drwn. By: KELLEN FUJISHIN
	Dwg. #: 1/17	Nxt Asb: NA	Date: 7/12/2020	Scale: 1:8	Chkd. By: SP TEAM 45

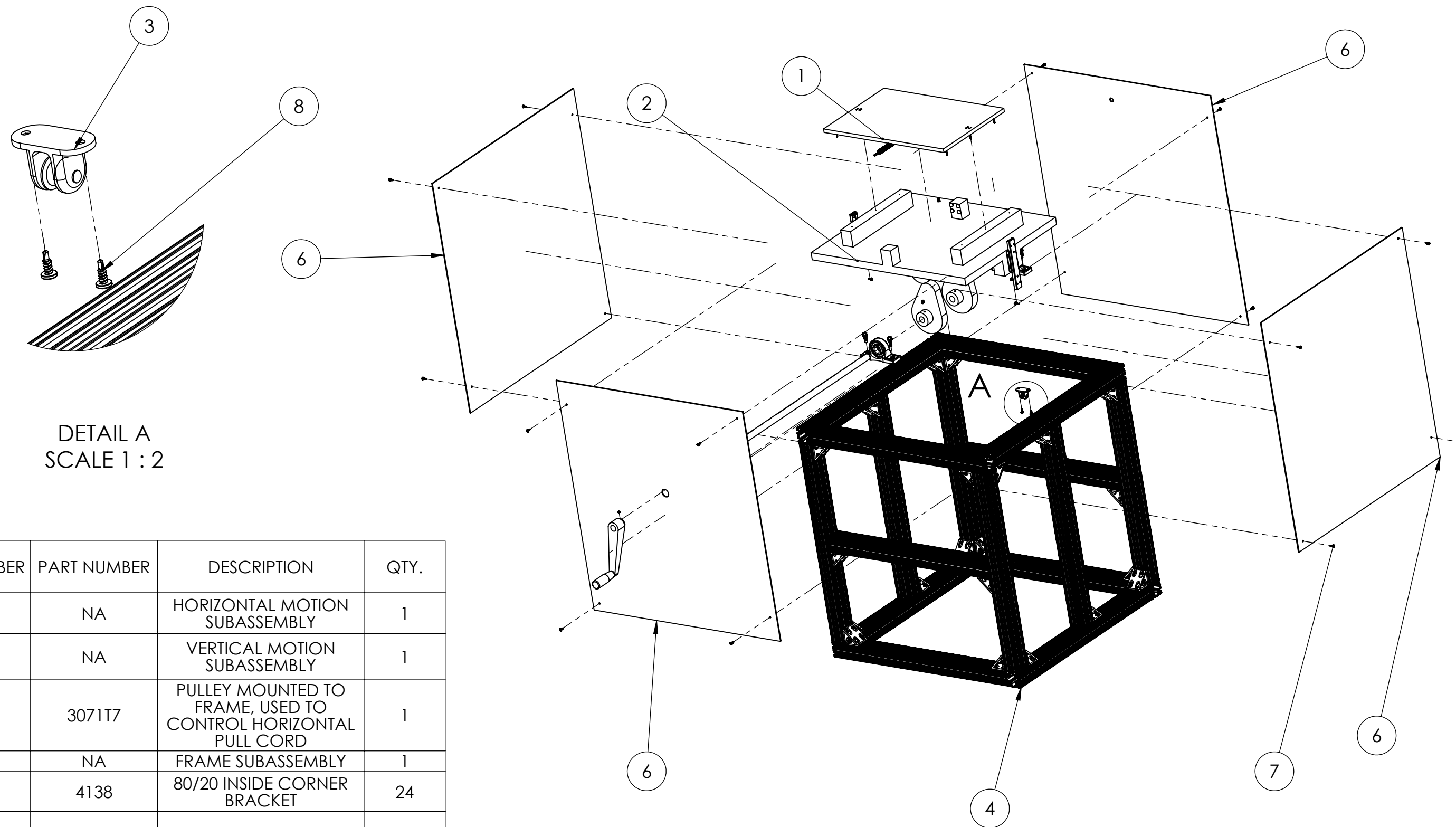

DETAIL A  
SCALE 1 : 2

ITEM NUMBER	PART NUMBER	DESCRIPTION	QTY.
1	NA	HORIZONTAL MOTION SUBASSEMBLY	1
2	NA	VERTICAL MOTION SUBASSEMBLY	1
3	3071T7	PULLEY MOUNTED TO FRAME, USED TO CONTROL HORIZONTAL PULL CORD	1
4	NA	FRAME SUBASSEMBLY	1
5	4138	80/20 INSIDE CORNER BRACKET	24
6	508	28 IN. X 30 IN. X 0.118 IN. ACRYLIC FRAME CASING PANELS	4
7	4122	#8 1/2 IN. PHILLIPS PAN-HEAD SELF-DRILLING SCREWS - 4 TO SECURE EACH CASING PANEL, 2 TO SECURE PULLEY TO FRAME	18

Cal Poly Mechanical Engineering  
ME 429 - SPR 2020

Lab Section: 03  
Dwg. #: 2/17

SP DRAWINGS  
Nxt Asb: NA

Title: FULL SHAKE TABLE ASSEMBLY  
Date: 7/12/2020 Scale: 1:12

Drwn. By: KELLEN FUJISHIN  
Chkd. By: SP TEAM 45

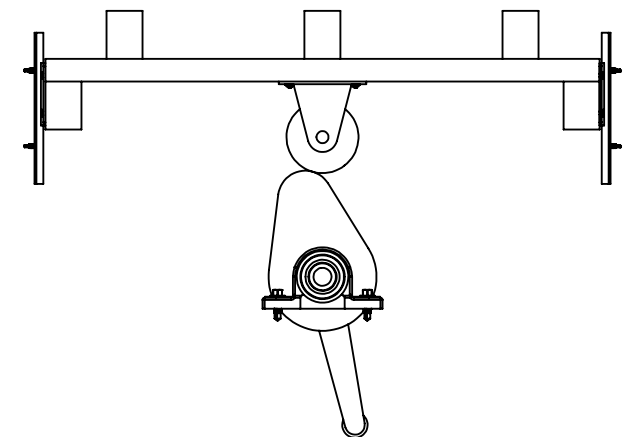
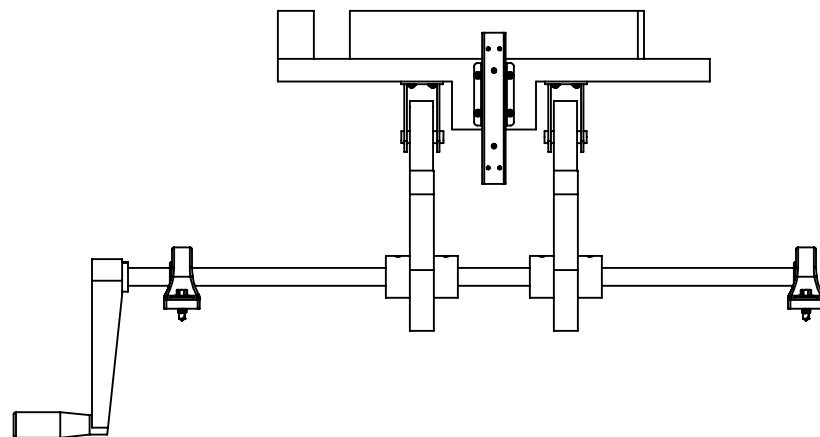
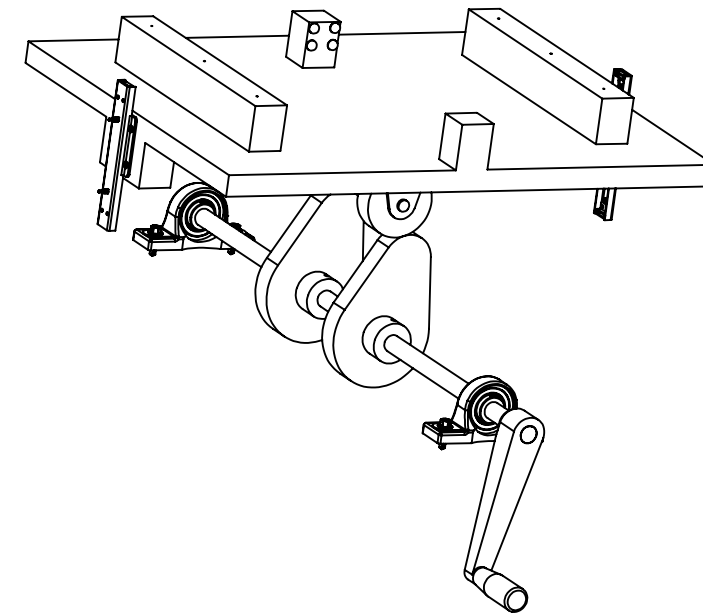
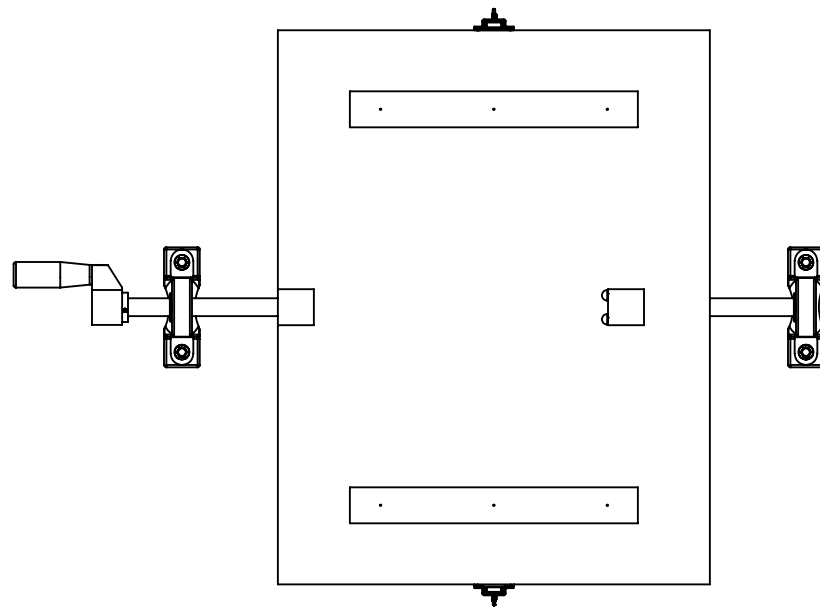

Cal Poly Mechanical Engineering ME 429 - SPR 2020	Lab Section: 03	SP DRAWINGS	Title: VERT. MOTION SUBASSEMBLY		Drwn. By: KELLEN FUJISHIN
	Dwg. #: 3/17	Nxt Asb: FULL	Date: 7/12/2020	Scale: 1:8	Chkd. By: SP TEAM 45

ITEM NUMBER	PART NUMBER	DESCRIPTION	QTY.
1	NA	VERTICAL MOTION PLATFORM SUBASSEMBLY	1
2	NA	MAIN SHAFT CAM	2
3	812198	1/4 IN.-20 X 3/8 IN. INTERNAL HEX STAINLESS-STEEL SOCKET SET SCREW - 2 PER CAM	4
4	5947K52	1045 CARBON STEEL SHAFT, 3/4 IN. DIAMETER, 36 IN. LONG	1
5	6004K87-6004K61	24.8 MM WIDE RAIL FOR SIDE-MOUNT BALL BEARING CARRIAGE	2
6	4112	#8 1/2 IN. PHILLIPS PAN-HEAD SELF-DRILLING SCREWS - 2 PER RAIL	4
7	6004K13	SIDE-MOUNTED BALL BEARING CARRIAGE	2
8	802788	M4-0.7 X 25 MM PHILLIPS PAN HEAD ZINC PLATED MACHINE SCREW - 4 PER CARRIAGE	8
9	2407T64	CASTER WHEEL, 3 IN. DIAMETER	2
10	809021	#10 X 3/4 IN. PHILLIPS ROUND HEAD ZINC PLATED WOOD SCREW - 4 PER CASTER WHEEL	8
11	6357K43	MOUNTED ACETAL BALL BEARING	2
12	838472	5/16 IN. X 1 IN. EXTERNAL HEX FLANGE HEX-HEAD SELF-DRILLING SCREWS - 2 PER BEARING	4
13	6473K55	CRANK HANDLE W/ REVOLVING GRIP	1
14	812138	# 10-32 X 3/16 IN. STAINLESS STEEL RECESSED HEX SOCKET CAP SCREW	1
15	9541K8	SBR RUBBER THREADED BUMPER	4

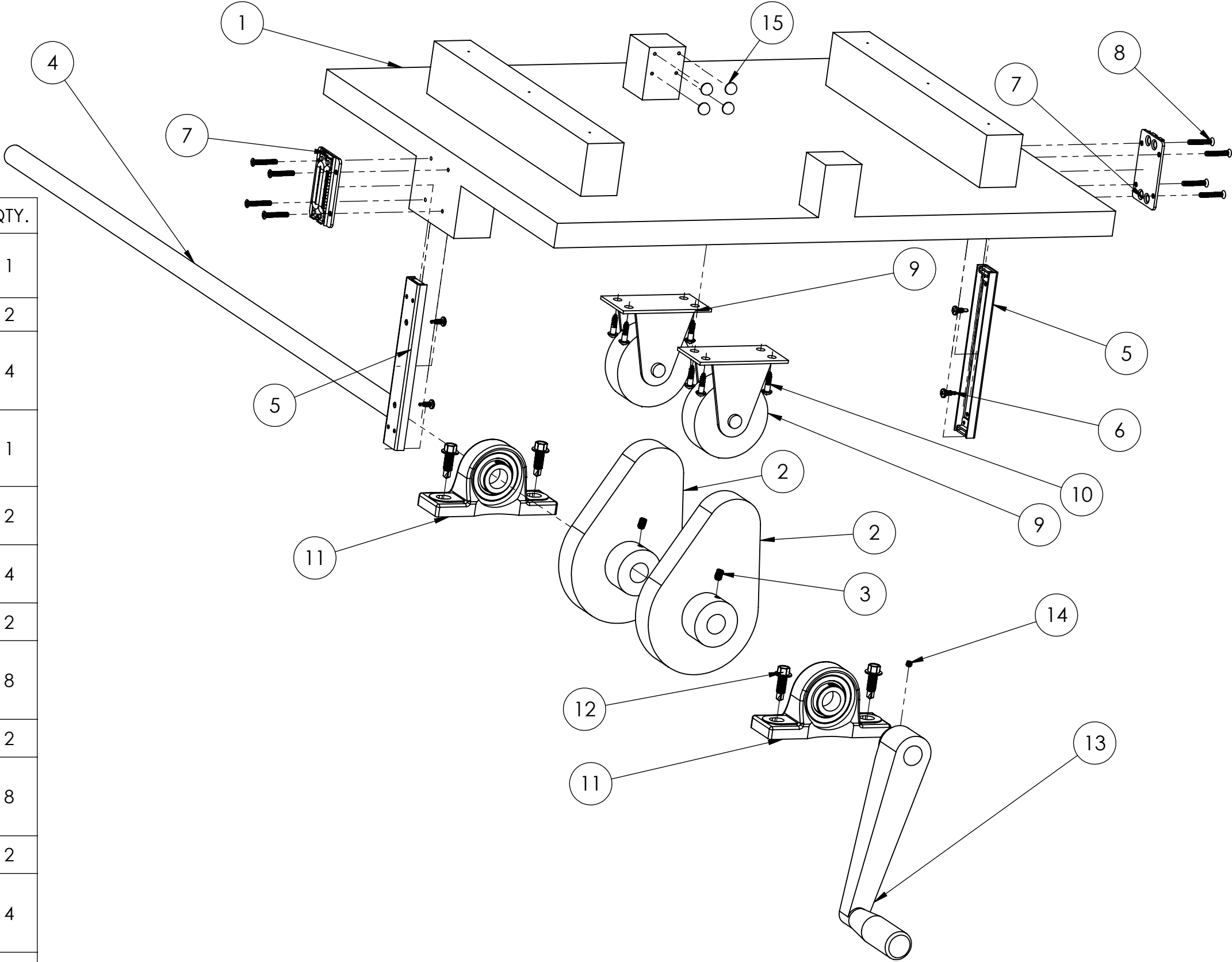

Cal Poly Mechanical Engineering ME 429 - SPR 2020	Lab Section: 03	SP DRAWINGS	Title: VERT. MOTION SUBASSEMBLY		Drwn. By: KELLEN FUJISHIN
	Dwg. #: 4/17	Nxt Asb: FULL	Date: 7/12/2020	Scale: 1:4	Chkd. By: SP TEAM 45

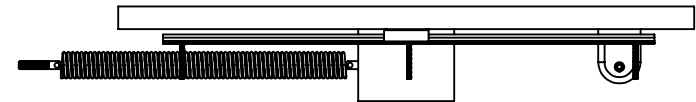
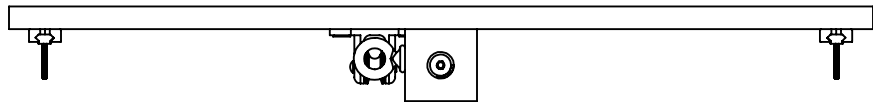
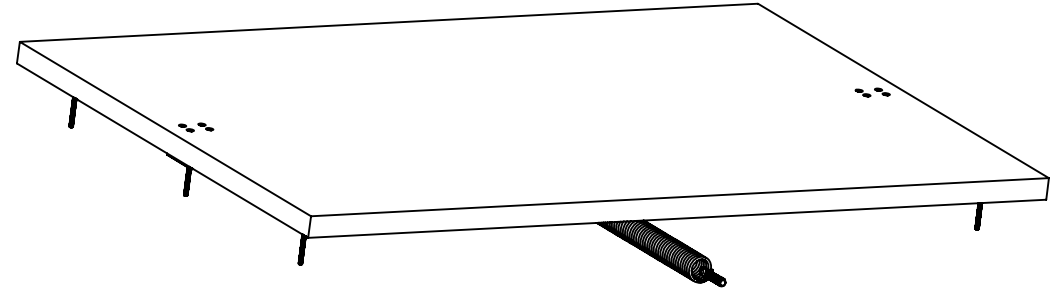
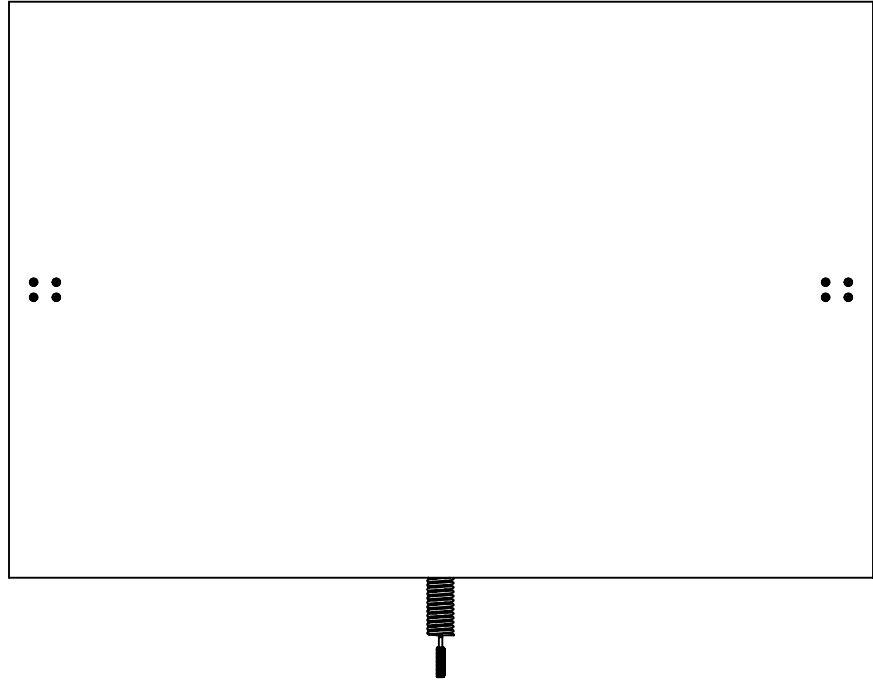

Cal Poly Mechanical Engineering ME 429 - SPR 2020	Lab Section: 03	SP DRAWINGS	Title: HORIZ. MOTION SUBASSEMBLY		Drwn. By: KELLEN FUJISHIN
	Dwg. #: 5/17	Nxt Asb: FULL	Date: 7/12/2020	Scale: 1:4	Chkd. By: SP TEAM 45



ITEM NUMBER	PART NUMBER	DESCRIPTION	QTY.
1	NA	HORIZONTAL MOTION PLATFORM ASSEMBLY	1
2	9829K11	ANODIZED ALUMINUM GUIDE RAIL - 260 MM	2
3	5318	M2-0.4 X 20 MM PHILLIPS PAN-HEAD MACHINE SCREWS - 3 PER RAIL	6
4	9829K1	ALUMINUM SLEEVE BEARING CARRIAGE	2
5	13658	M2-0.4 X 14 MM PHILLIPS FLAT-HEAD MACHINE SCREWS - 4 PER CARRIAGE	8
6	30295T22	FIBERGLASS ROUTING EYEBOLT - CONNECTS TO PULL CORD TO CONTROL HORIZONTAL MOTION	1
7	9432K73	MUSIC-WIRE STEEL EXTENSION SPRING WITH HOOK ENDS	1
8	95907A110	EXTENSION SPRING STUD ANCHOR	2
9	3071T7	PULLEY MOUNTED TO PLATFORM, USED TO CONTROL HORIZONTAL PULL CORD PULLEY FOR PULL CORD	1
10	809011	#10 X 1/2 IN. PHILLIPS FLAT HEAD ZINC PLATED WOOD SCREW	2
NA	2677T5	NYLON PULL CORD, 2 FT LONG AND 1/4 IN. DIAMETER, ATTACHES TO EYEBOLT AND IS THREADED THROUGH PULLEYS TO THE OUTSIDE CASING (NOT PICTURED DUE TO CAD LIMITATIONS)	1

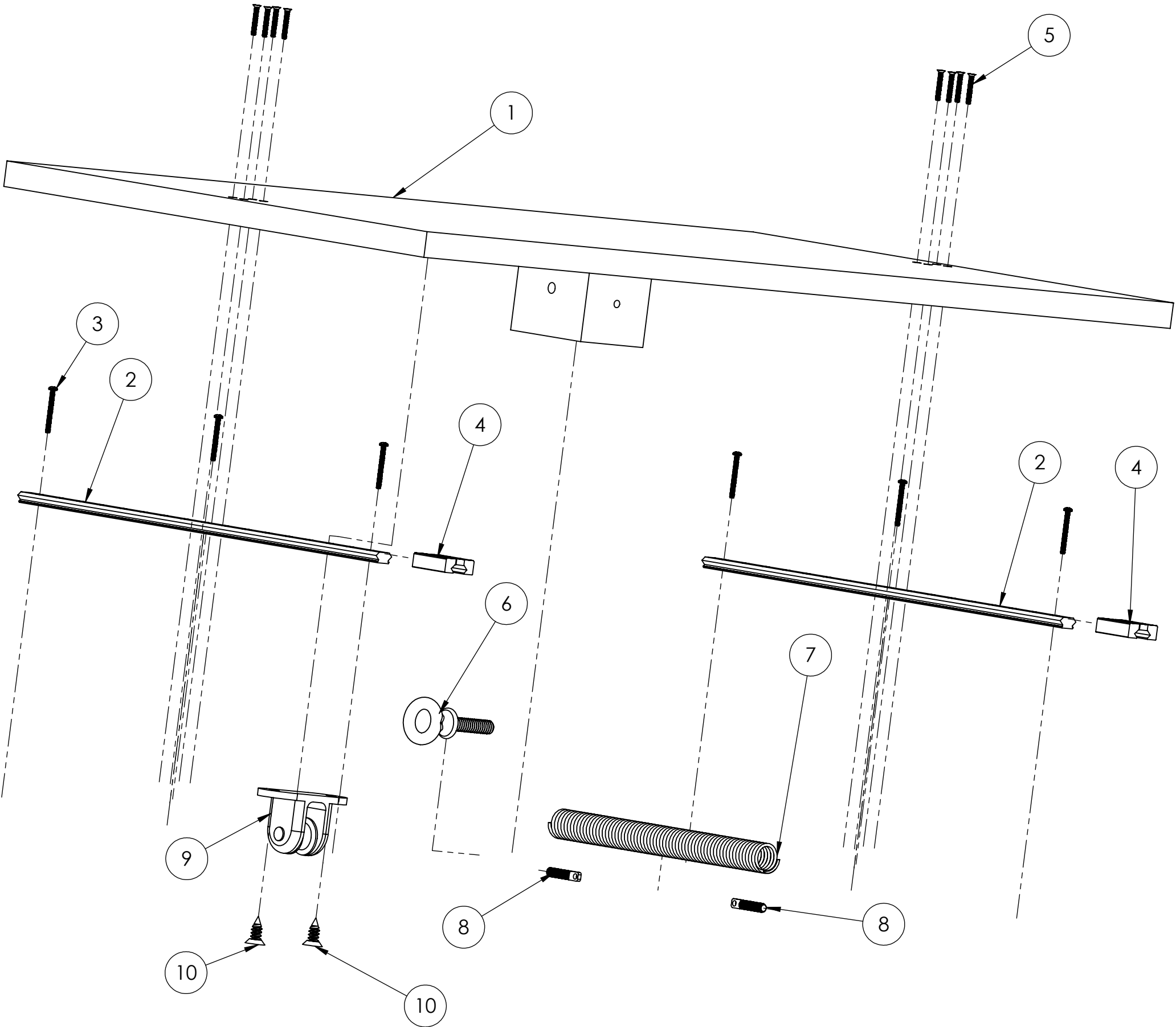

Cal Poly Mechanical Engineering ME 429 - SPR 2020	Lab Section: 03	SP DRAWINGS	Title: HORIZ. MOTION SUBASSEMBLY		Drwn. By: KELLEN FUJISHIN
	Dwg. #: 6/17	Nxt Asb: FULL	Date: 7/12/2020	Scale: 1:2	Chkd. By: SP TEAM 45



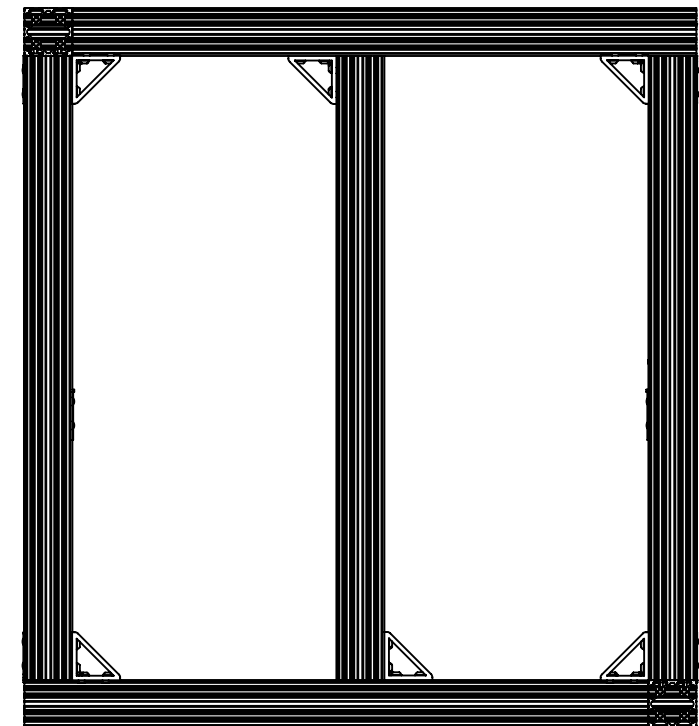
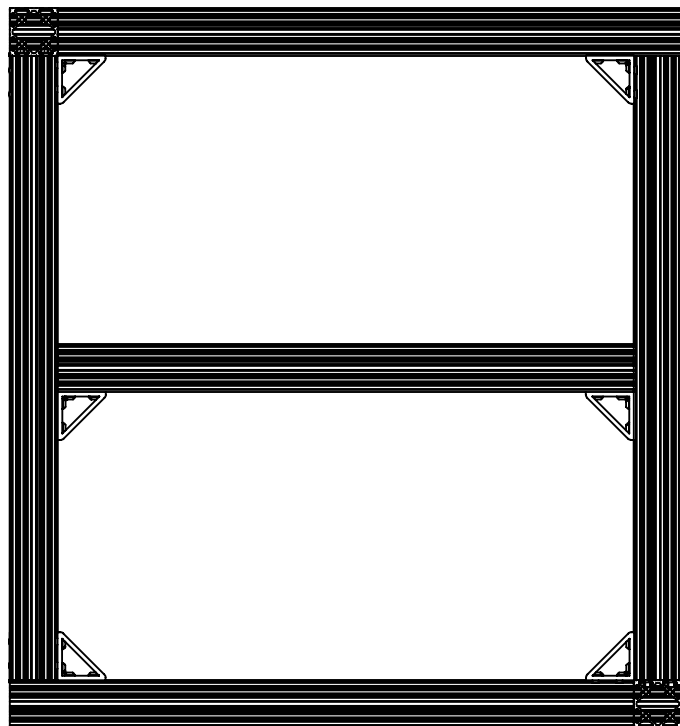
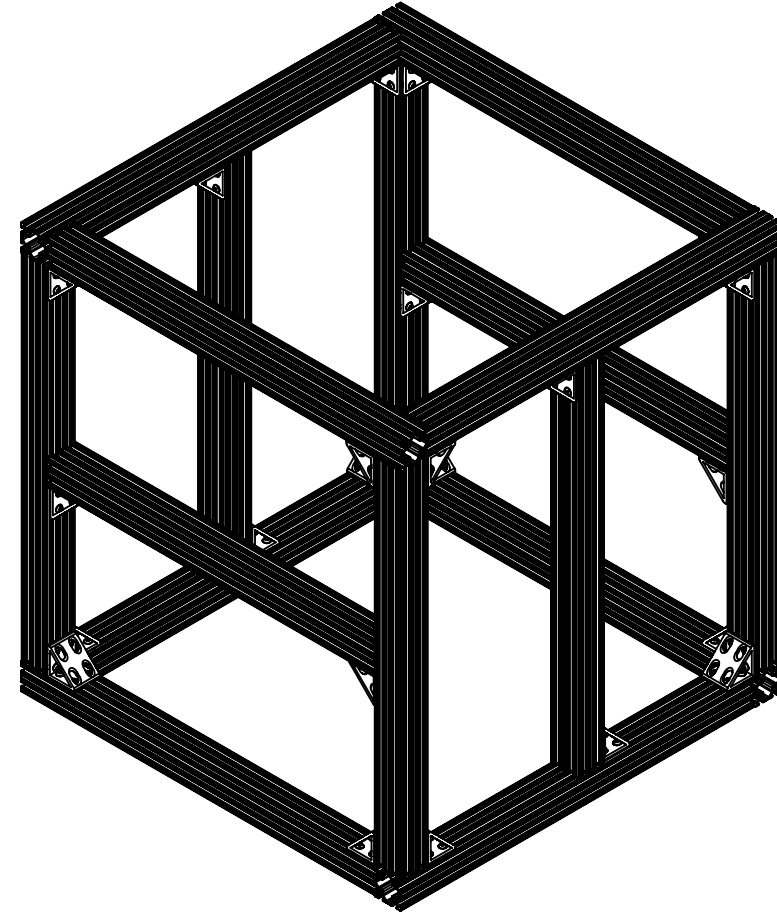
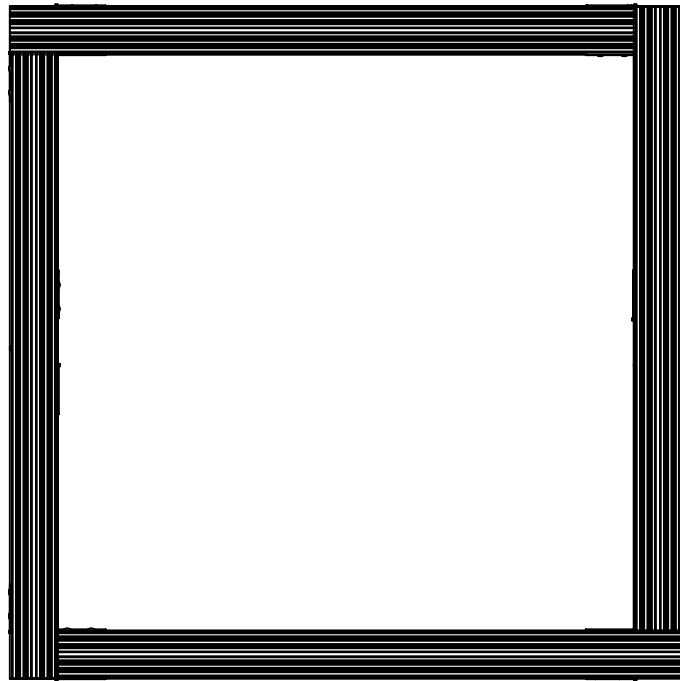

Cal Poly Mechanical Engineering ME 429 - SPR 2020	Lab Section: 03	SP DRAWINGS	Title: FRAME SUBASSEMBLY		Drwn. By: KELLEN FUJISHIN
	Dwg. #: 7/17	Nxt Asb: FULL	Date: 7/20/2020	Scale: 1:8	Chkd. By: SP TEAM 45

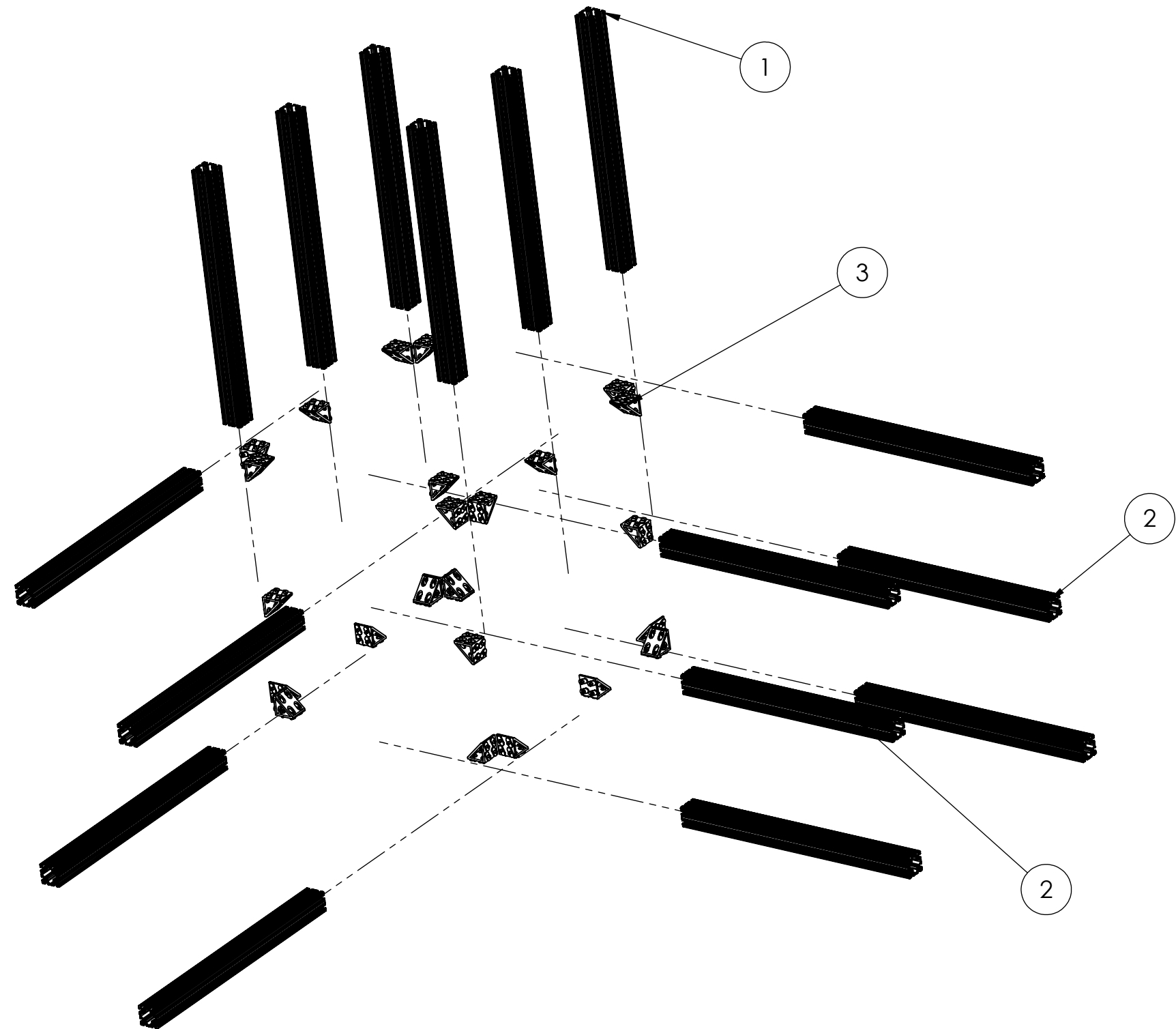

ITEM NUMBER	PART NUMBER	DESCRIPTION	QTY.
1	2020	80/20 2 IN. X 2 IN. X 26 IN. ALUMINUM FRAME PIECE	14
2	2020	80/20 2 IN. X 2 IN. X 24 IN. ALUMINUM FRAME PIECE	2
3	NA	BRACKET SUBASSEMBLY	24

Cal Poly Mechanical Engineering ME 429 - SPR 2020	Lab Section: 03	SP DRAWINGS	Title: FRAME SUBASSEMBLY		Drwn. By: KELLEN FUJISHIN
	Dwg. #: 8/17	Nxt Asb: FULL	Date: 7/20/2020	Scale: 1:12	Chkd. By: SP TEAM 45

ITEM NUMBER	PART NUMBER	DESCRIPTION	QTY.
1	103078	MAIN VERTICAL PLATFORM PANEL, CUT FROM 0.5 IN. X 2 FT. X 4 FT. PLYWOOD	1
2	161640	RAIL BLOCK, CUT FROM 2 IN. X 4 IN. X 96 IN. WHITEWOOD STUD	2
3	161640	SPRING BLOCK, CUT FROM 2 IN. X 4 IN. X 96 IN. WHITEWOOD STUD	1
4	161640	BUMPER BLOCK, CUT FROM 2 IN. X 4 IN. X 96 IN. WHITEWOOD STUD	1
5	161640	CARRIAGE BLOCK, CUT FROM 2 IN. X 4 IN. X 96 IN. WHITEWOOD STUD	2
6	801862	#8 X 2 IN. PHILLIPS FLAT HEAD ZINC PLATED WOOD SCREW	28

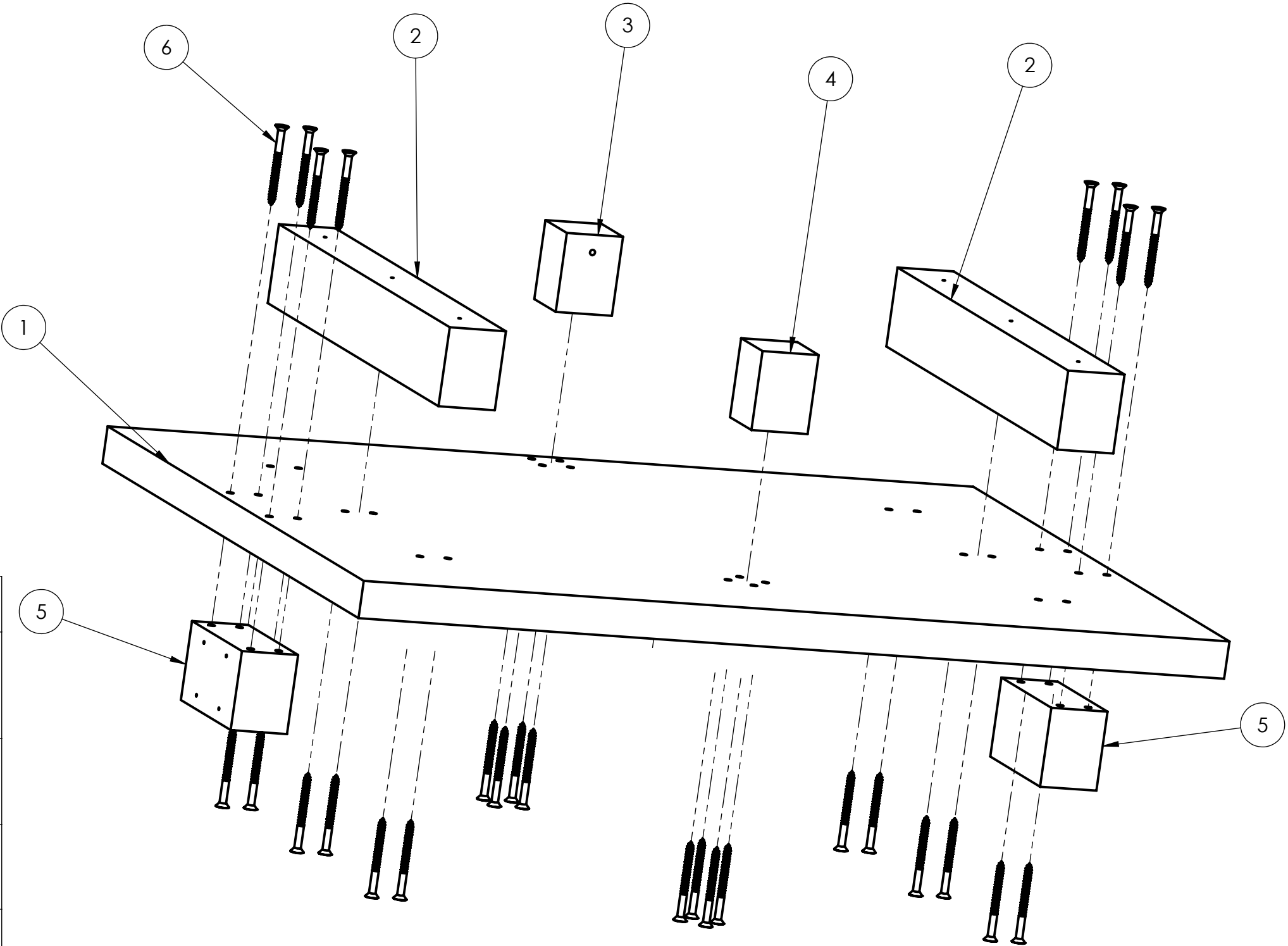

Cal Poly Mechanical Engineering ME 429 - SPR 2020	Lab Section: 03	SP DRAWINGS	Title: VERTICAL PLATFORM SUBASSY		Drwn. By: KELLEN FUJISHIN
	Dwg. #: 9/17	Nxt Asb: VERTICAL	Date: 7/20/2020	Scale: 1:3	Chkd. By: SP TEAM 45

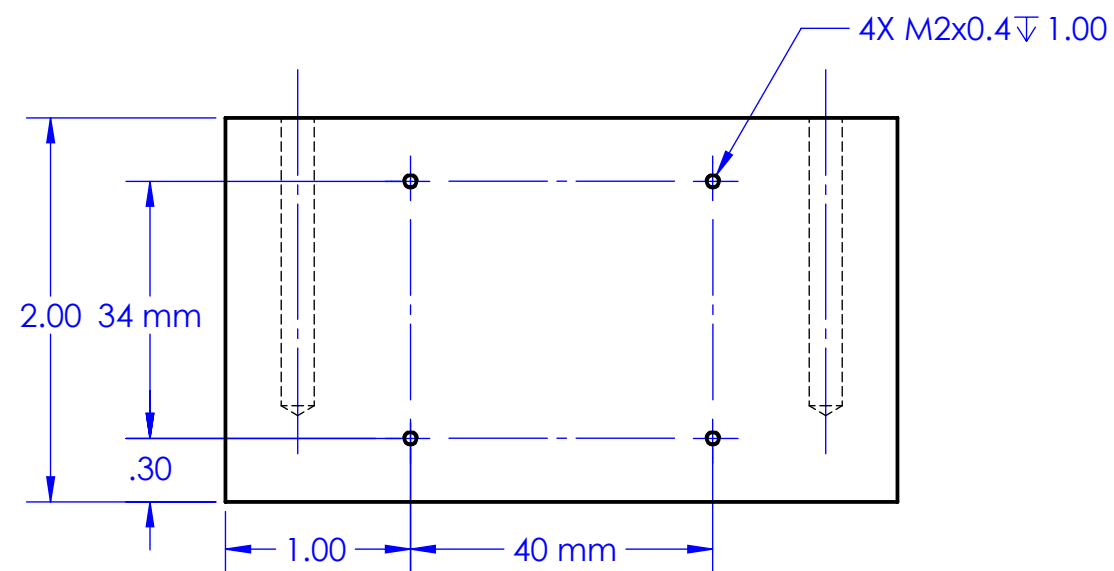
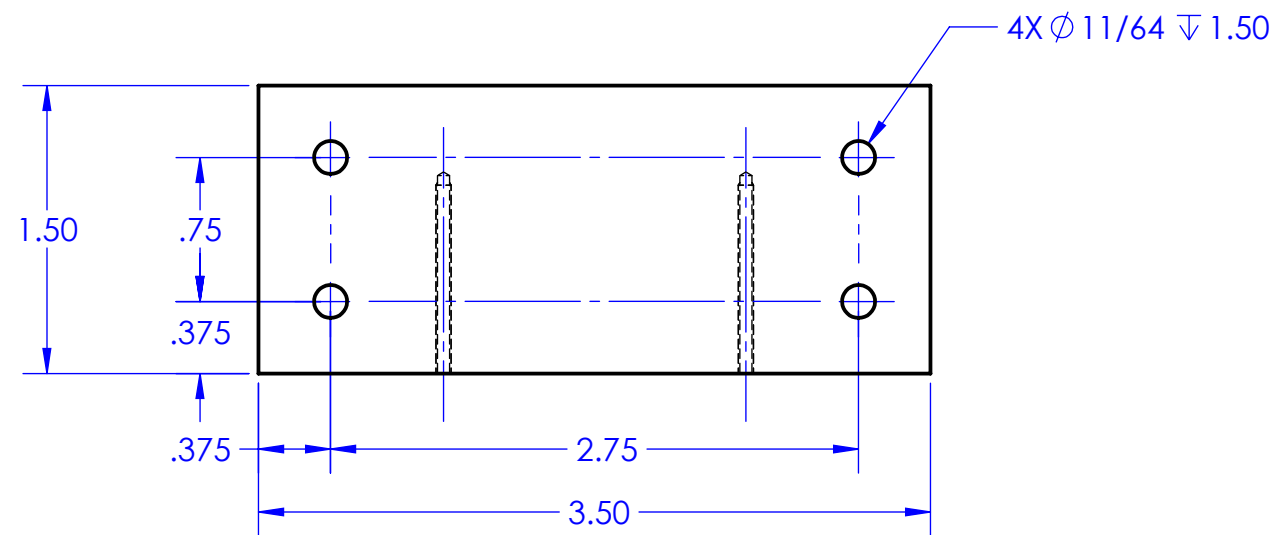

CARRIAGE BLOCK

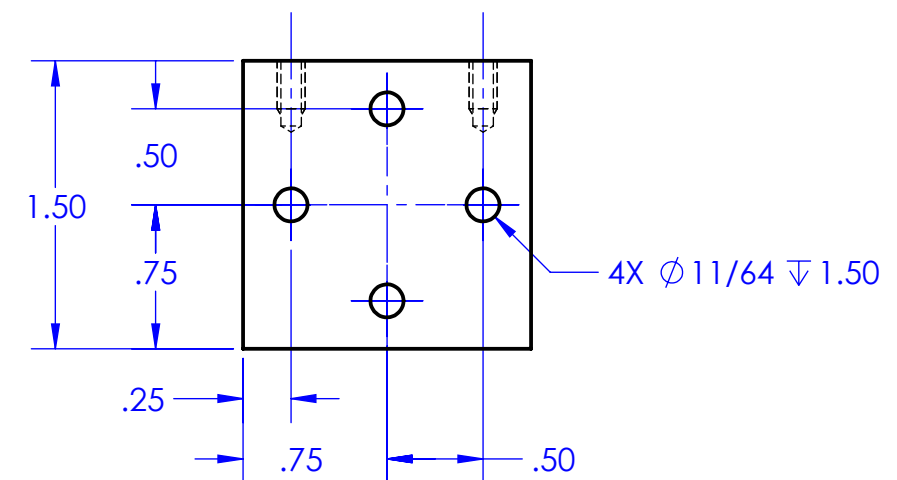
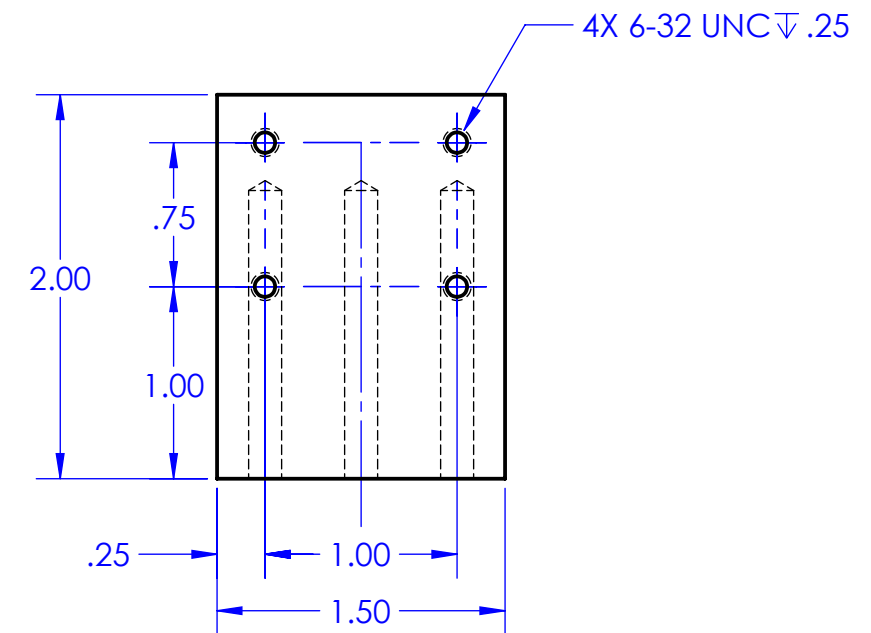

BUMPER BLOCK

NOTES:

UNLESS OTHERWISE SPECIFIED:

1. ALL DIMS. IN INCHES
2. TOLERANCES:  
X.XX =  $\pm 0.05$   
X.XXX =  $\pm 0.005$
3. METRIC DIMENSIONS BASED ON CARRIAGE MOUNTING HOLES
4. SAND ROUGH EDGES
5. GLUE WOOD COMPONENTS TOGETHER BEFORE DRILLING HOLES

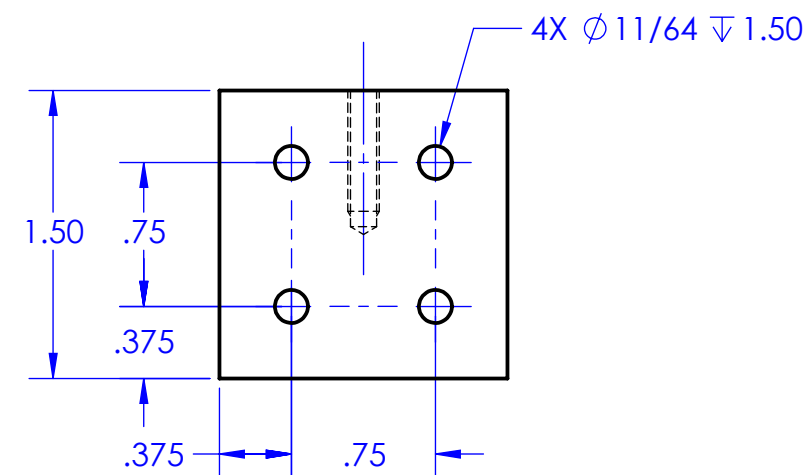
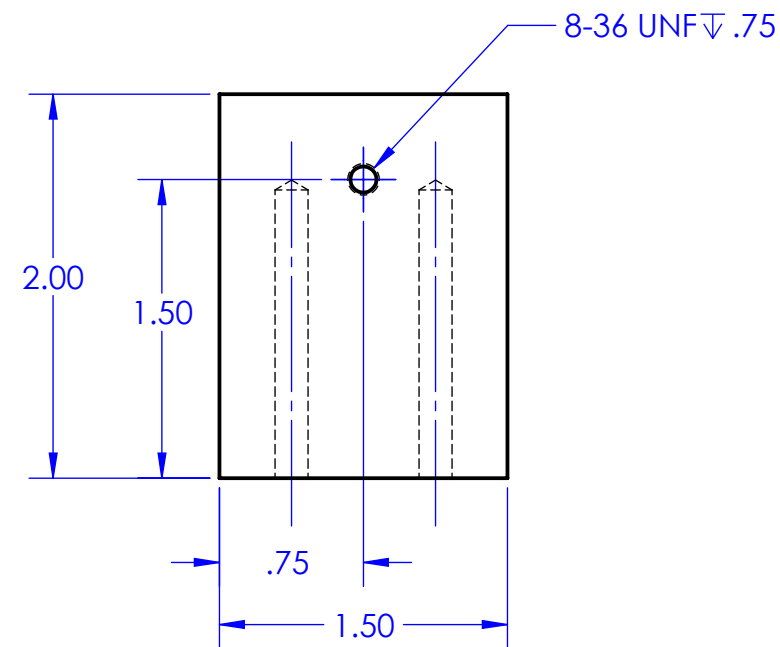

SPRING BLOCK  
SCALE: 1:1

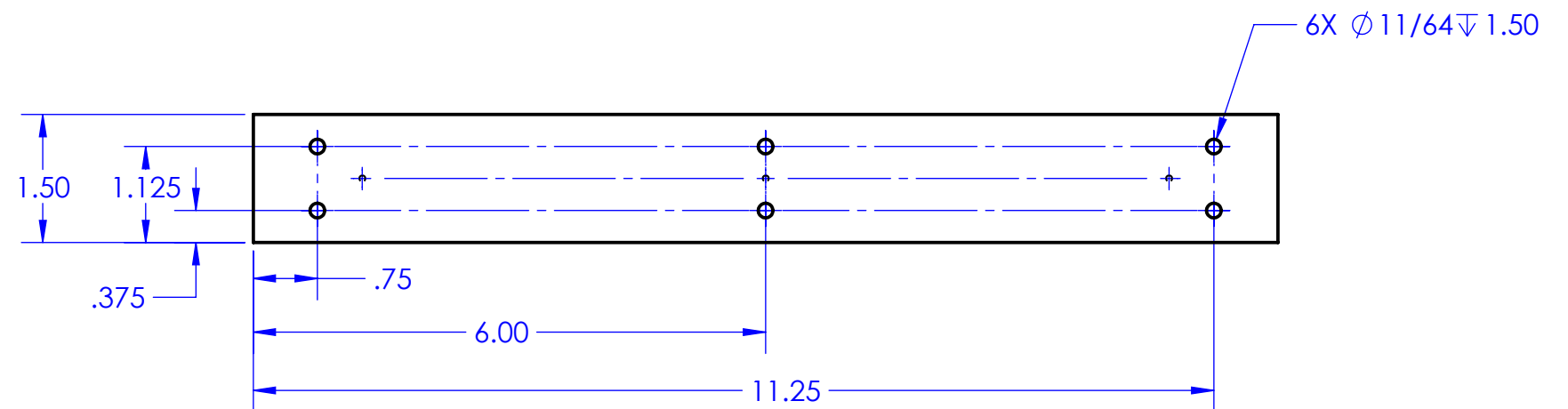
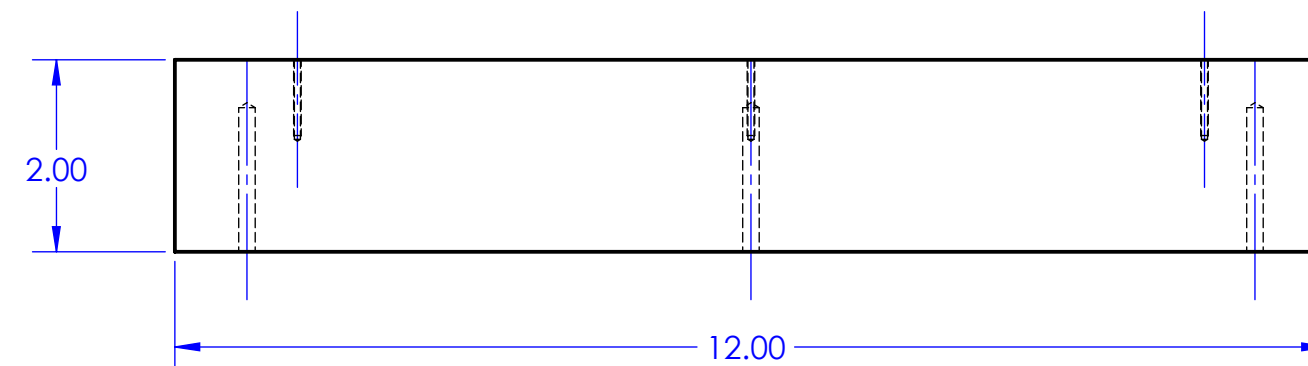
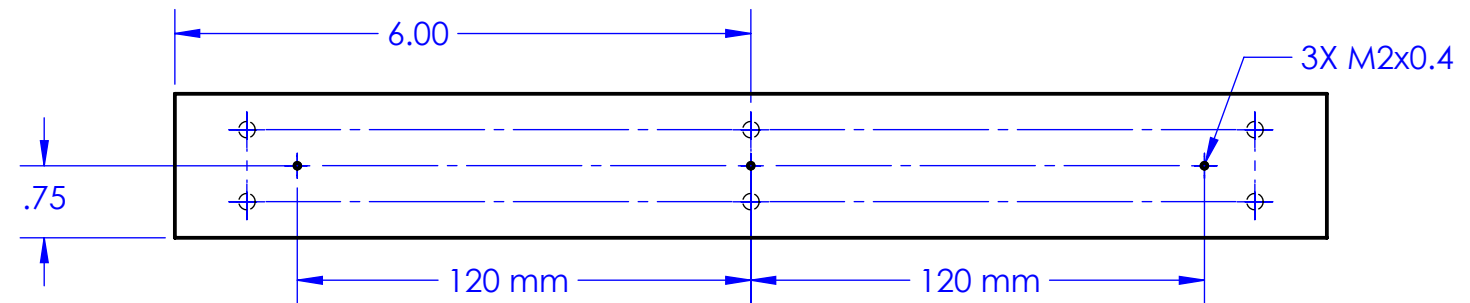

RAIL BLOCK  
SCALE: 1:2

NOTES:

UNLESS OTHERWISE SPECIFIED:

1. ALL DIMS. IN INCHES
2. TOLERANCES:  
X.XX =  $\pm 0.05$   
X.XXX =  $\pm 0.005$
3. METRIC DIMENSIONS BASED ON RAIL MOUNTING HOLES
4. SAND ROUGH EDGES
5. GLUE WOOD COMPONENTS TOGETHER BEFORE DRILLING HOLES

Cal Poly Mechanical Engineering  
ME 429 - SPR 2020

Lab Section: 03  
Dwg. #: 11/17

SP DRAWINGS  
Nxt Asb: VERT. PLAT.

Title: VERT. PLAT. COMPONENTS  
Date: 7/21/2020 Scale: N/A

Drwn. By: FUJISHIN AND LOO  
Chkd. By: SP TEAM 45

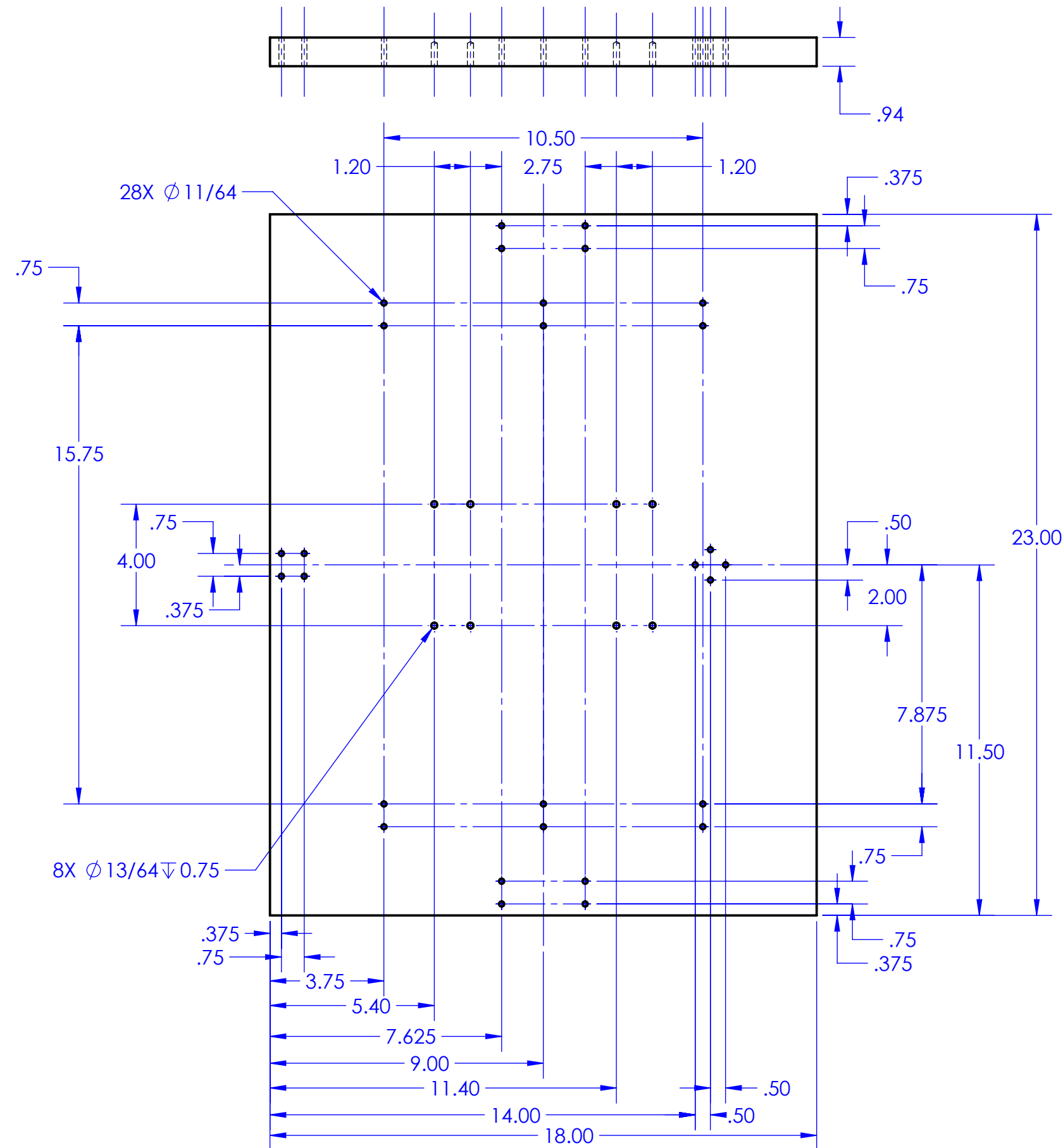

- NOTES:
- UNLESS OTHERWISE SPECIFIED:
1. ALL DIMS. IN INCHES
  2. TOLERANCES:  
X.XX =  $\pm 0.05$   
X.XXX =  $\pm 0.005$
  3. OVERALL THICKNESS COMPRISED OF TWO 0.47 IN PANELS GLUED TOGETHER
  4. OVERALL LENGTH DEPENDENT ON DISTANCE BETWEEN CARRIAGES
  5. SAND ROUGH EDGES
  6. GLUE WOOD COMPONENTS TOGETHER BEFORE DRILLING HOLES

Cal Poly Mechanical Engineering  
ME 429 - SPR 2020

Lab Section: 03 SP DRAWINGS

Dwg. #: 12/17 Nxt Asb: VERT. PLAT.

Title: VERT. PLAT. COMPONENTS

Date: 7/21/2020

Scale: 1:4

Drwn. By: ALYSSON LOO

Chkd. By: SP TEAM 45

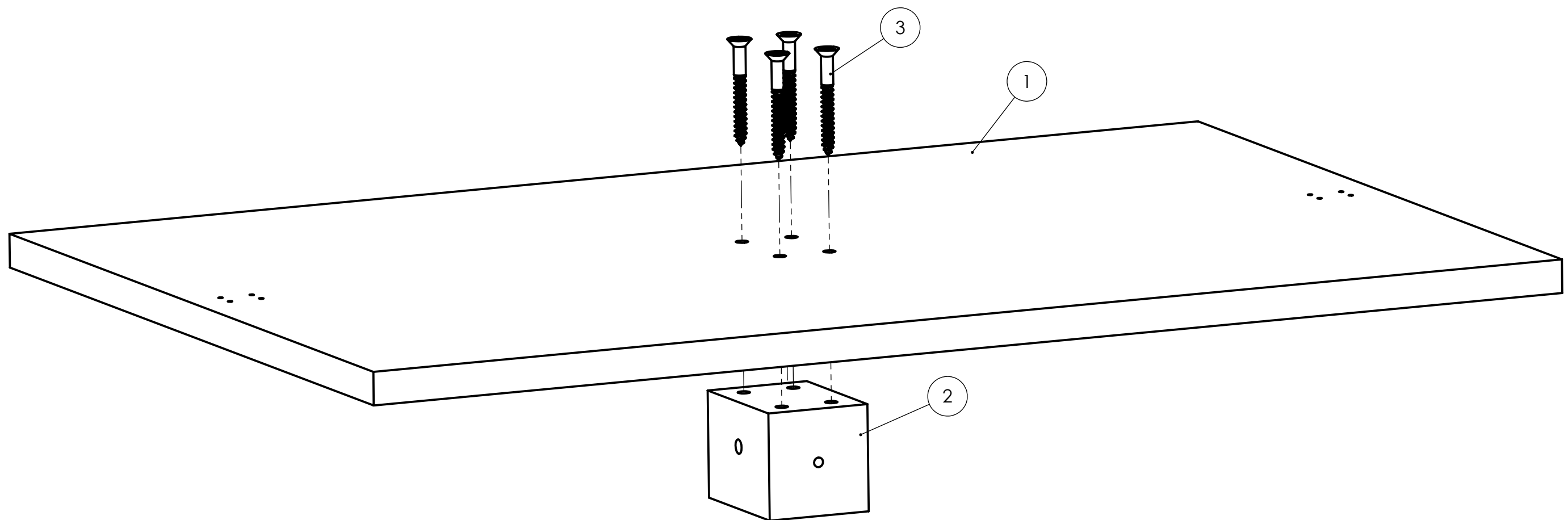

ITEM NO.	PART NUMBER	DESCRIPTION				QTY.
1	103078	0.472 IN X 12 IN X 18 IN PLATFORM CUT FROM 0.472 IN X 23.75 IN X 47.75 IN PLYWOOD				1
2	161640	1.50 IN X 2.00 IN X 1.50 IN BLOCK CUT FROM 1.5 IN X 3.5 IN X 96 IN WHITEWOOD				1
3	809721	#8 X 1-1/2 IN. PHILLIPS FLAT HEAD BRASS WOOD SCREW				4
Cal Poly Mechanical Engineering ME 429 - SPR 2020		Lab Section: 03	SP DRAWINGS	Title: HORIZ. PLAT. SUBASSY.		Drwn. By: ALYSSON LOO
		Dwg. #: 13/17	Nxt Asb: HORIZ.	Date: 7/20/2020	Scale: 2:3	Chkd. By: SP TEAM 45



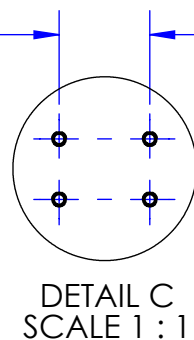
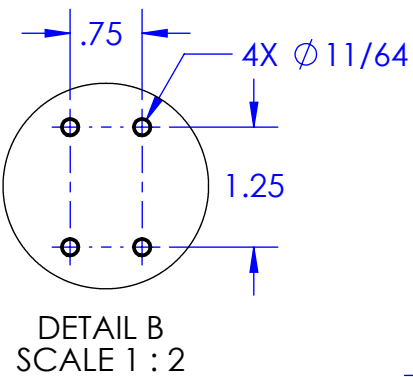
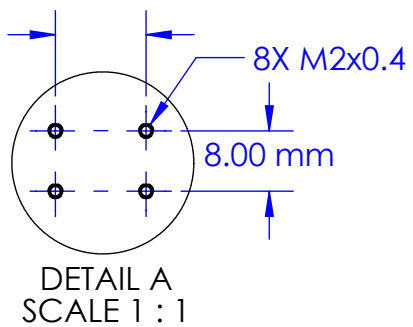
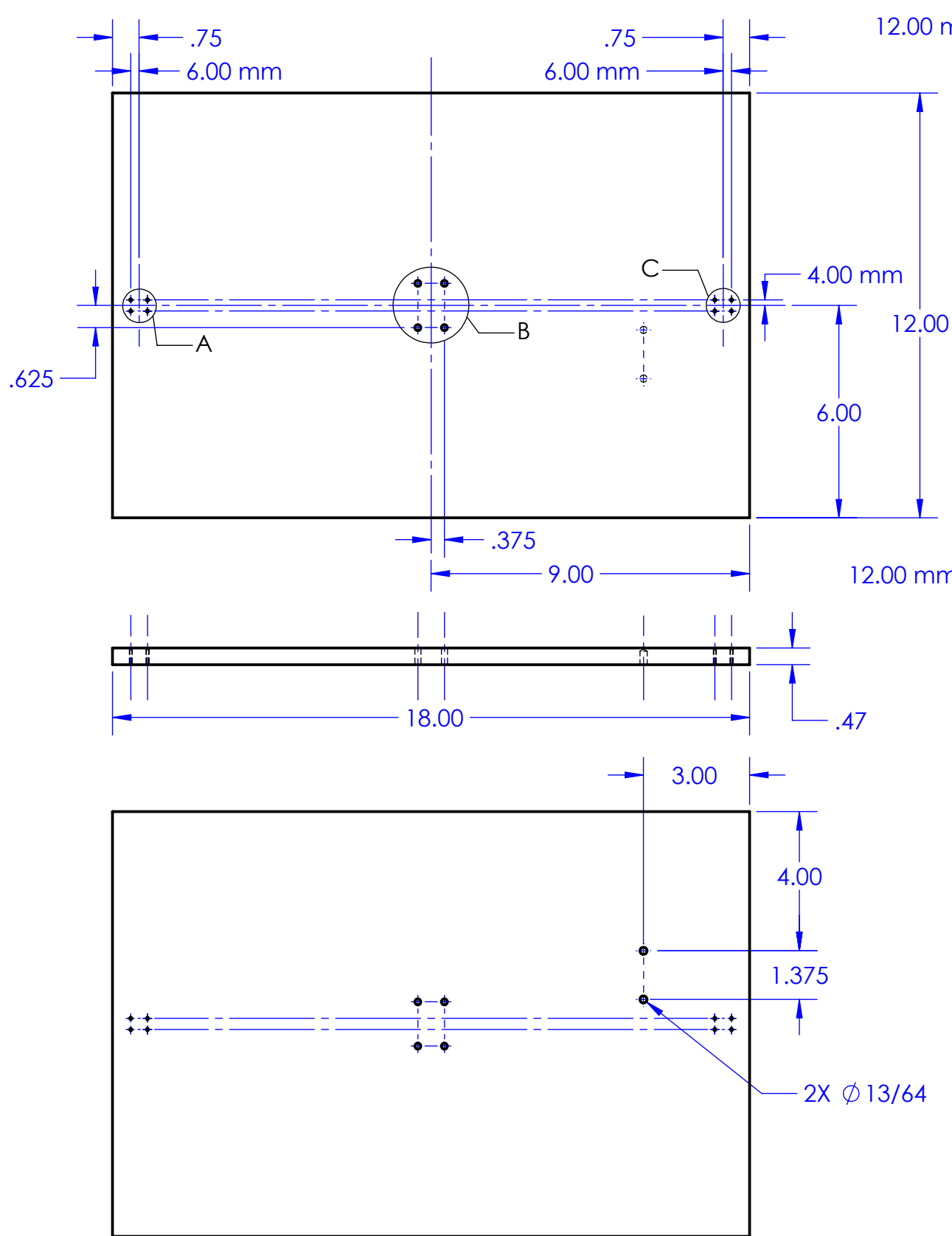

- NOTES:  
UNLESS OTHERWISE SPECIFIED:  
1. ALL DIMS. IN INCHES  
2. TOLERANCES:  
X.XX =  $\pm 0.05$   
X.XXX =  $\pm 0.005$   
3. METRIC DIMENSIONS BASED ON CARRIAGE MOUNTING HOLES  
4. SAND ROUGH EDGES  
5. GLUE WOOD COMPONENTS TOGETHER BEFORE DRILLING HOLES

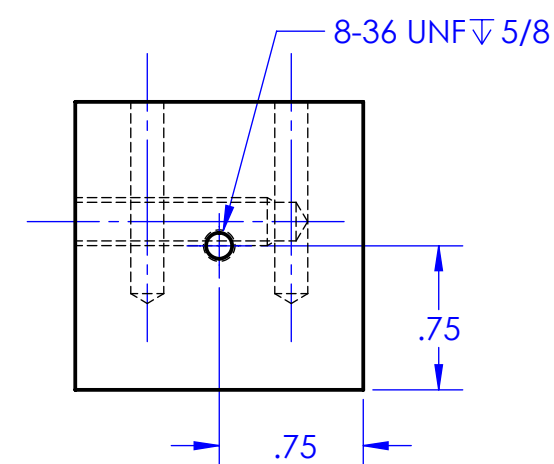
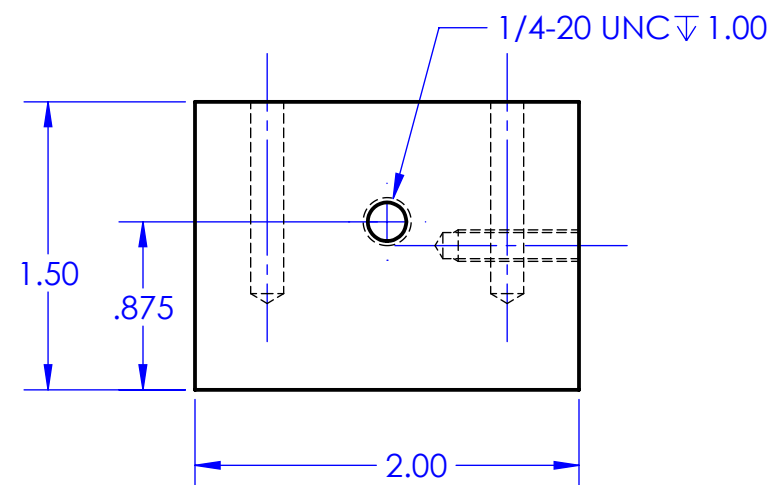
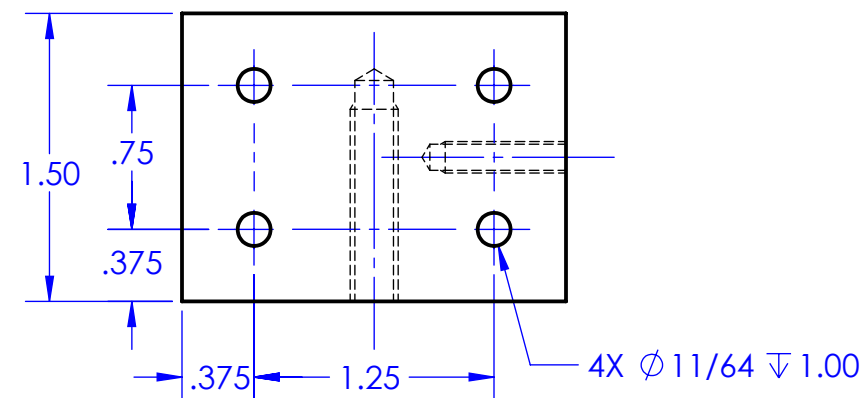

HORIZONTAL SPRING BLOCK  
SCALE: 1:1

MAIN HORIZONTAL PLATFORM PANEL  
SCALE: 1:4

Cal Poly Mechanical Engineering ME 429 - SPR 2020	Lab Section: 03 Dwg. #: 14/17	SP DRAWINGS Nxt Asb: HORIZ. PLAT.	Title: HORIZ. PLAT. COMPONENTS Date: 7/20/2020	Scale: N/A	Drwn. By: ALYSSON LOO Chkd. By: SP TEAM 45
--	----------------------------------	--------------------------------------	---	------------	---

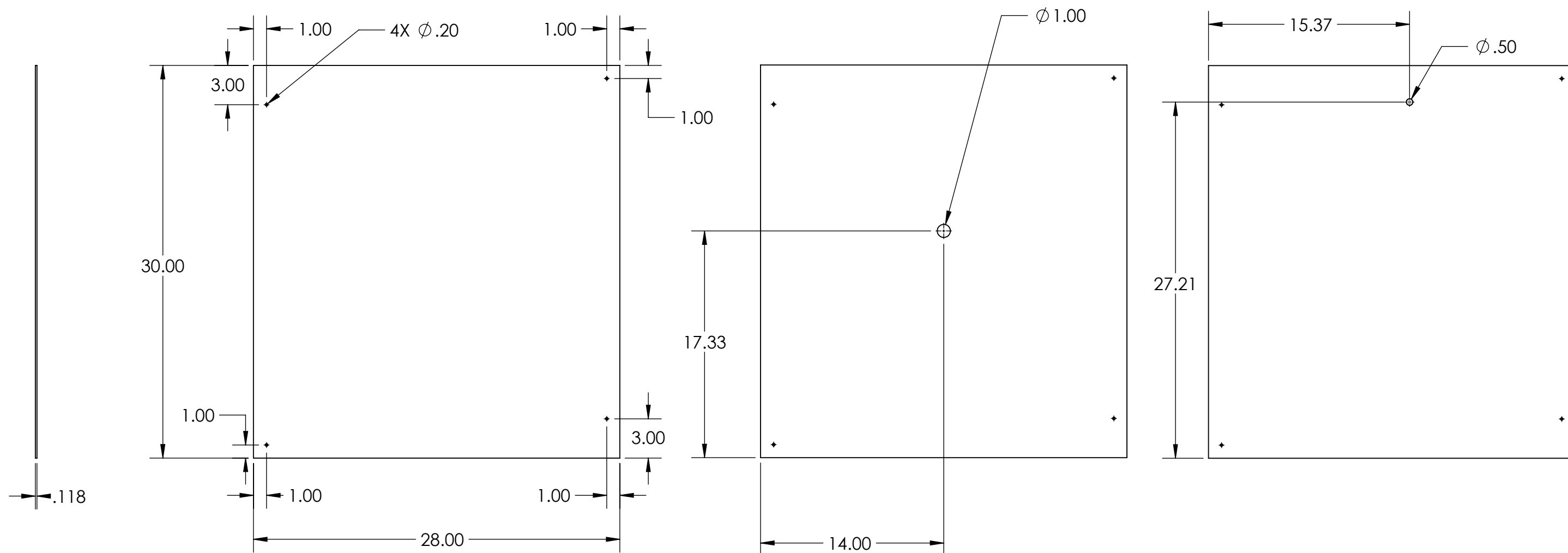

# NOTES:

1. ALL DIMENSIONS IN INCHES
2. MATERIAL: ACRYLIC
3. ALL TOLERANCES:  $\pm 0.100$
4. FINAL HOLE PLACEMENT SHAFT AND PULL CORD (LEFT AND RIGHT PANEL) WILL ULTIMATELY DEPEND ON SHAFT AND CORD POSITION
5. POSITIONS OF ALL  $\phi .20$  HOLES ARE SHOWN ON THE FRONT AND BACK PANELS

FRONT AND BACK COVER PANELS

LEFT COVER PANEL (CRANK SIDE)

RIGHT COVER PANEL

Cal Poly Mechanical Engineering ME 429 - SPR 2020	Lab Section: 03 Dwg. #: 15/17	SP DRAWINGS Nxt Asb: FULL	Title: 508 FRAME CASING PANELS Date: 7/13/2020	Drwn. By: KELLEN FUJISHIN Scale: 1:8	Chkd. By: SP TEAM 45
--	----------------------------------	------------------------------	---	---	----------------------

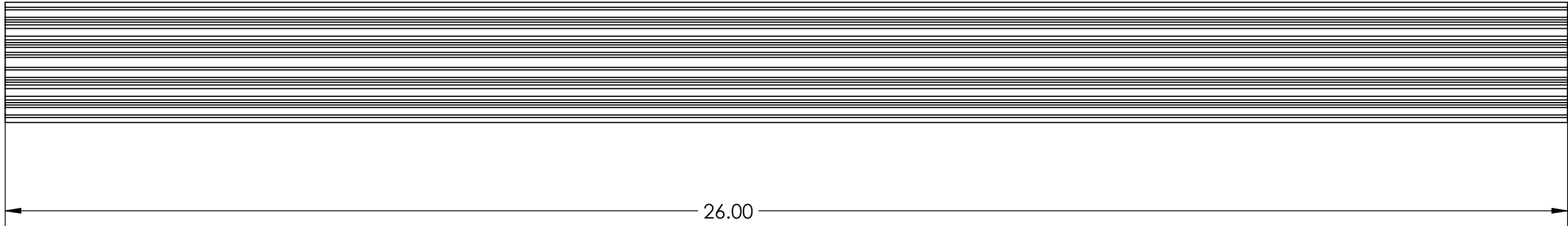

26 IN. LEG

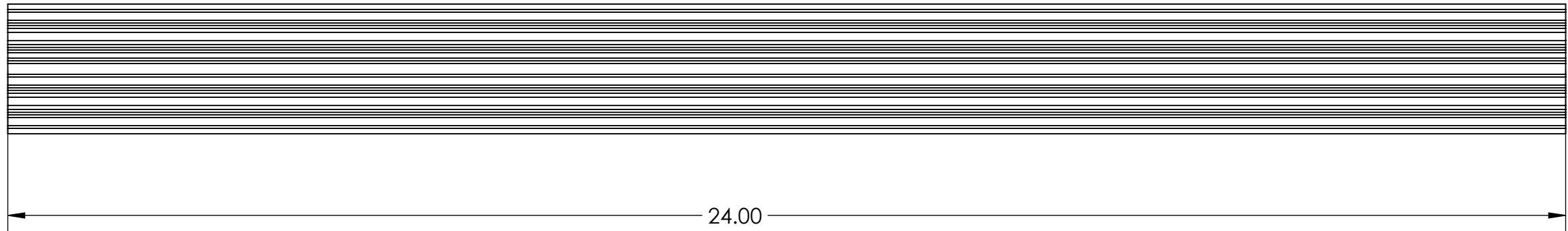

24 IN. LEG

NOTES:

1. SEE PURCHASED PART  
DRAWINGS FOR DIMENSIONED  
CROSS-SECTION

Cal Poly Mechanical Engineering ME 429 - SPR 2020	Lab Section: 03	SP DRAWINGS	Title: 2020 LEG		Drwn. By: KELLEN FUJISHIN
	Dwg. #: 16/17	Nxt Asb: FRAME	Date: 7/20/2020	Scale: 1:2	Chkd. By: SP TEAM 45

4

3

2

1

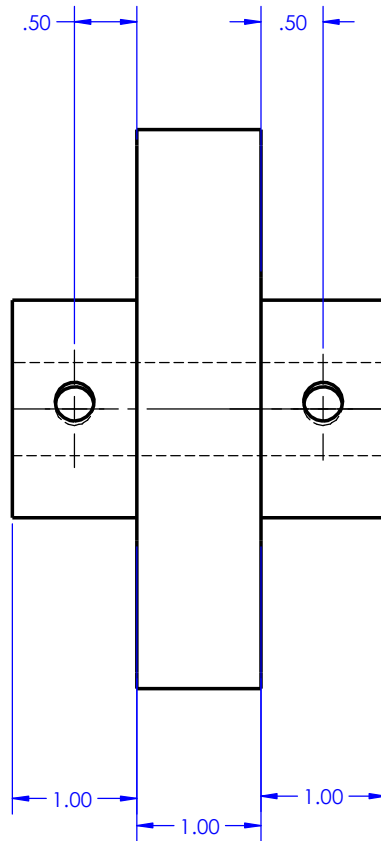

R1.125

 $\phi .75$  $\phi 1.75$ 

3.375

R2.250

**PROPRIETARY AND CONFIDENTIAL**  
THE INFORMATION CONTAINED IN THIS  
DRAWING IS THE SOLE PROPERTY OF  
<INSERT COMPANY NAME HERE>. ANY  
REPRODUCTION IN PART OR AS A WHOLE  
WITHOUT THE WRITTEN PERMISSION OF  
<INSERT COMPANY NAME HERE> IS  
PROHIBITED.

		UNLESS OTHERWISE SPECIFIED:		NAME	DATE	TITLE: <div>PRJ626 DRW #17</div>			
		DIMENSIONS ARE IN INCHES TOLERANCES: $\pm 0.01$ ANGULAR: MACH $\pm$ BEND $\pm$ TWO PLACE DECIMAL $\pm$ THREE PLACE DECIMAL $\pm$	DRAWN	J.C.	5/28/20				
			CHECKED						
			ENG APPR.						
			MFG APPR.			SIZE DWG. NO. REV <div>B Main Cam</div>			
		INTERPRET GEOMETRIC TOLERANCING PER:	Q.A.						
		AI 6061-T	COMMENTS: Material: Al 6061-T						
		FINISH							
NEXT ASSY	USED ON					SCALE: 1:1		WEIGHT:	SHEET 1 OF 1
APPLICATION		DO NOT SCALE DRAWING							

4

3

2

1

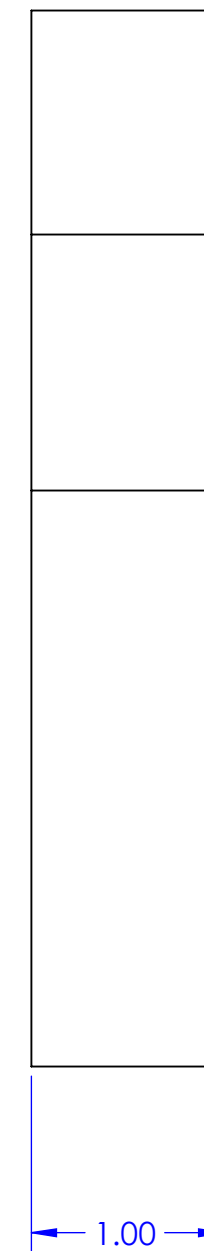
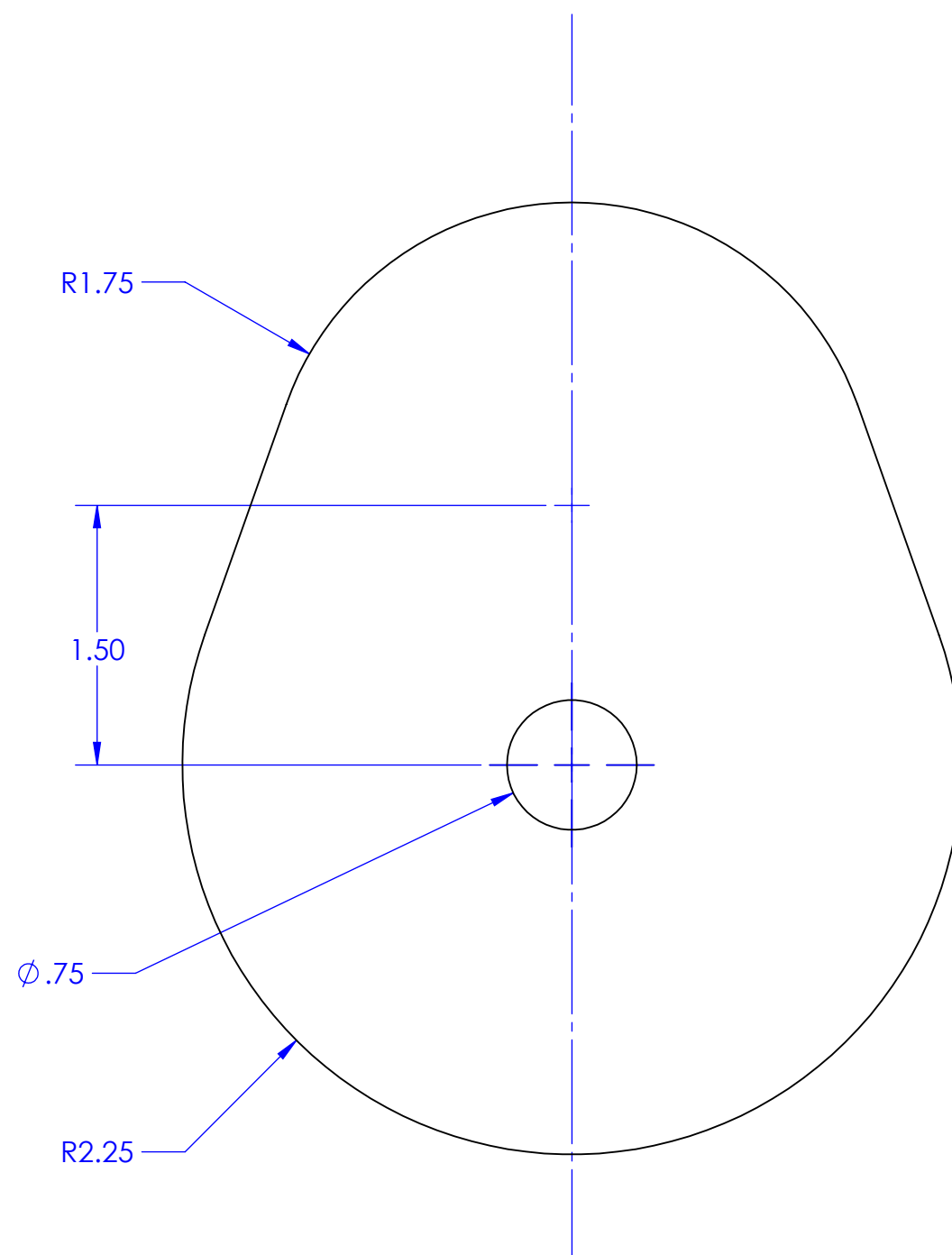
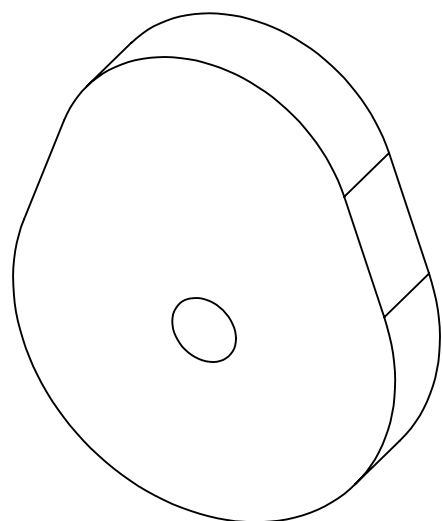

- NOTES:
1. ALL DIMENSIONS IN INCHES
  2. TOLERANCES:
    1.  $X.XX = \pm 0.05$
  3. MATERIAL: ALUMNIUM
  4. COLLAR DESIGN UNCHANGED - SEE DRAWING 17 FOR DIMENSIONS

Cal Poly Mechanical Engineering ME 430 - FALL 2020	Lab Section: 03	SP DRAWINGS	Title: REVISED CAM PROFILE		Drwn. By: FUJISHIN
	Dwg. #: 17A/17	Nxt Asb: VERT.	Date: 11/20/2020	Scale: 1:1	Chkd. By: SP TEAM 45

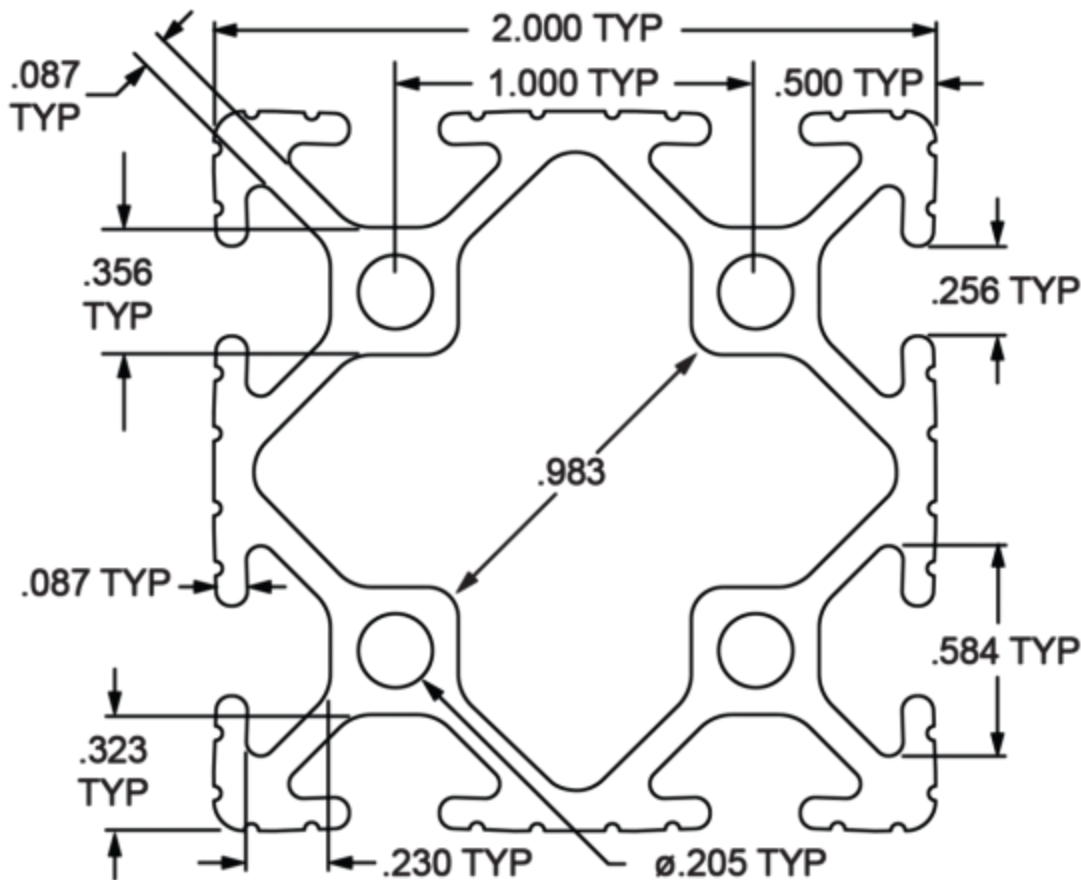

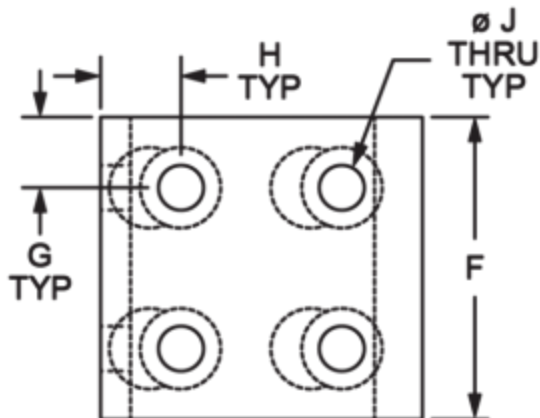
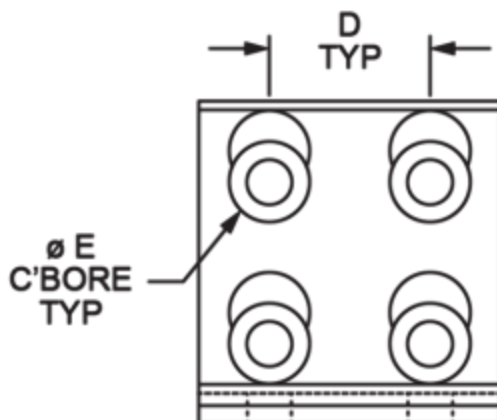
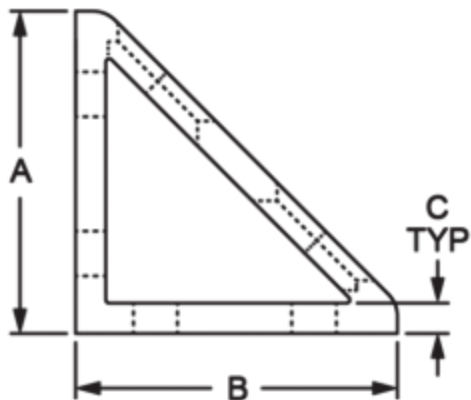



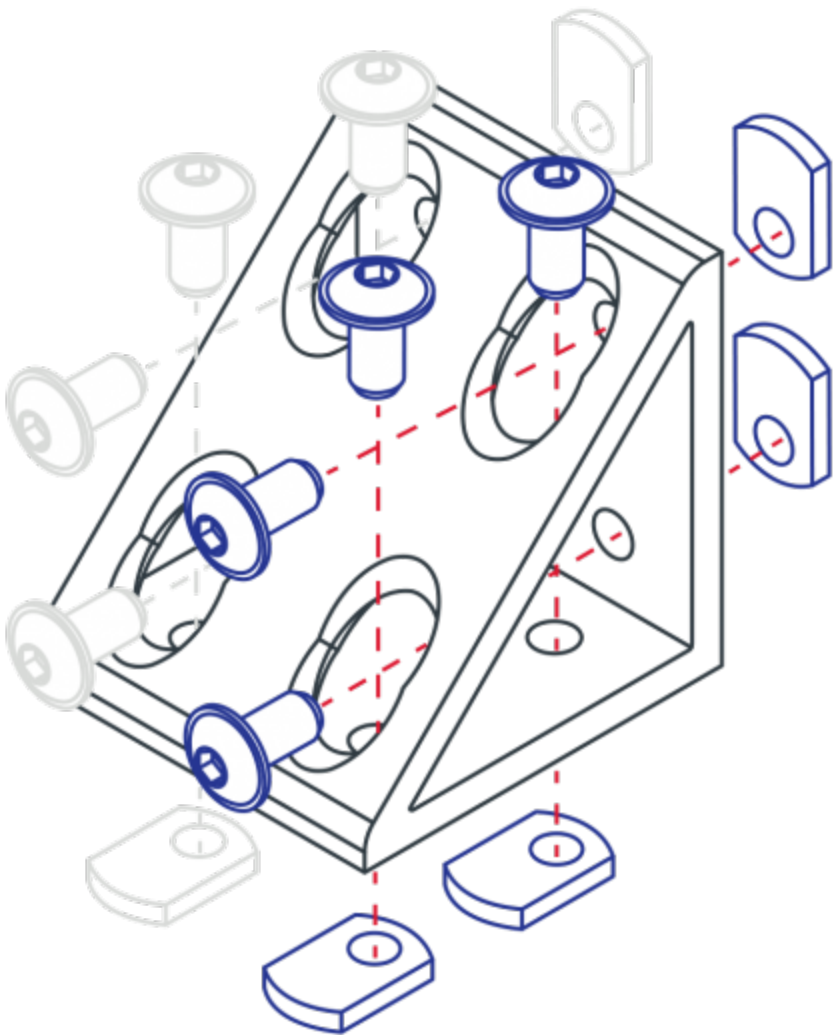

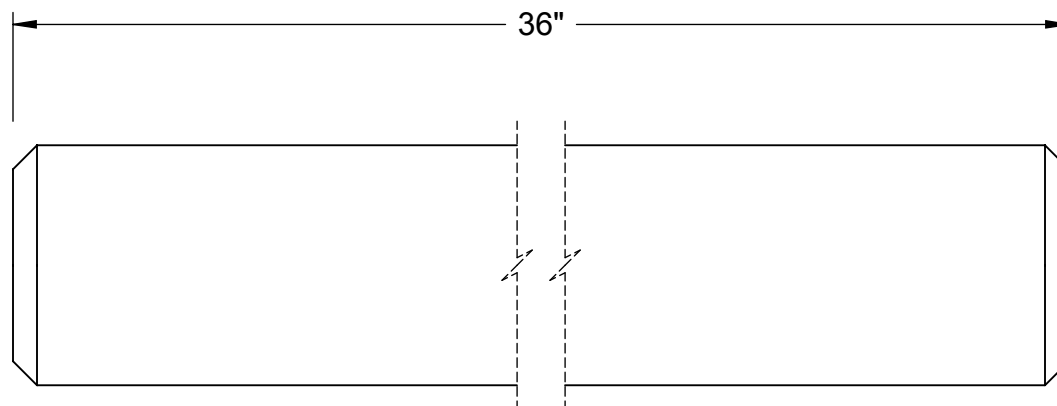
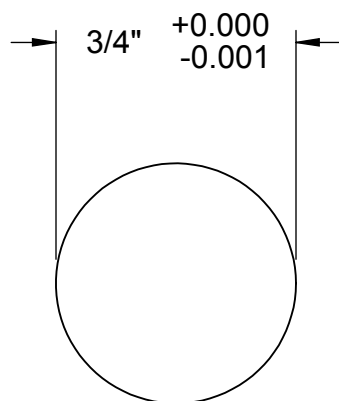
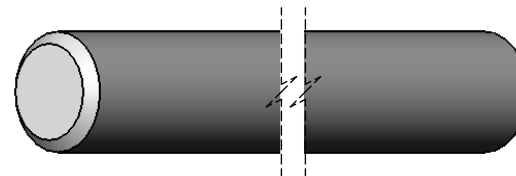

Straightness Tolerance is 1/8" per 10 Feet

<b>McMASTER-CARR</b> <small>CAD</small>	PART NUMBER	<b>5947K52</b>
	Drive Shaft	
	Information in this drawing is provided for reference only.	

<http://www.mcmaster.com>  
© 2012 McMaster-Carr Supply Company

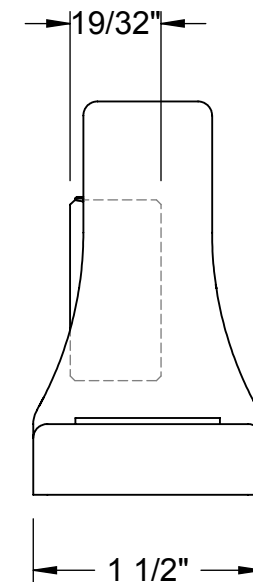
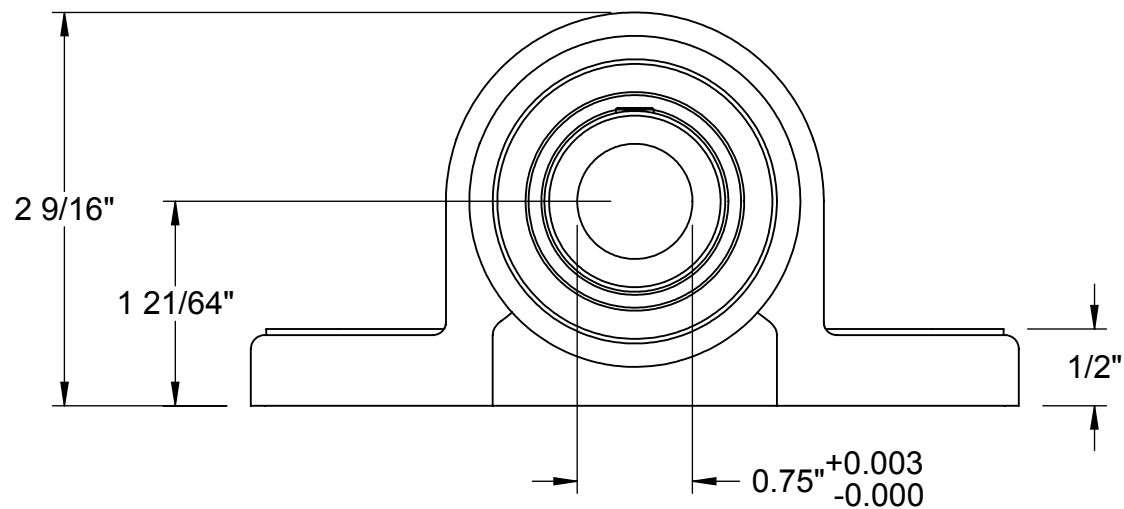
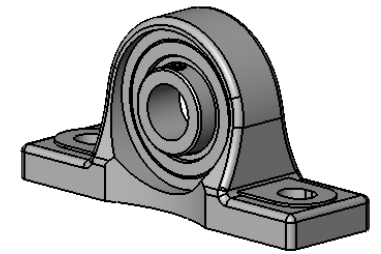
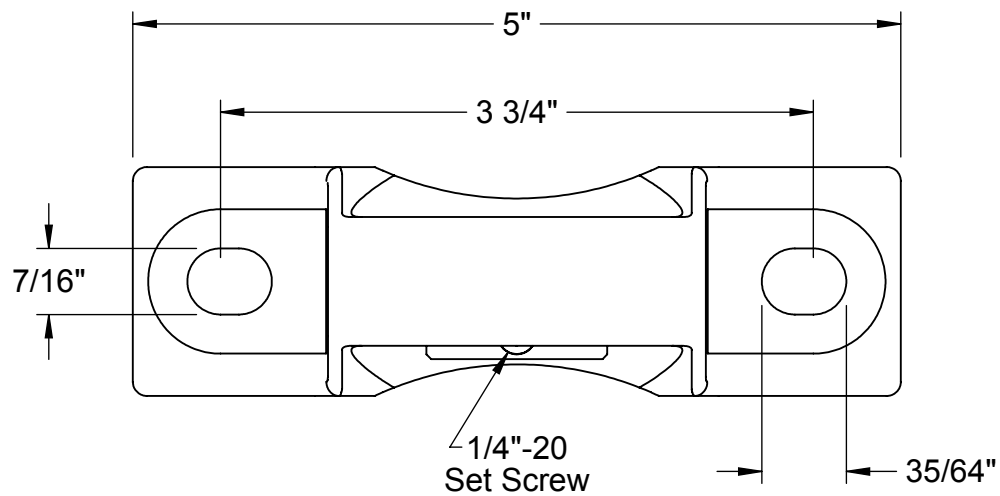

<b>McMASTER-CARR</b> <small>CAD</small> <a href="http://www.mcmaster.com">http://www.mcmaster.com</a> © 2017 McMaster-Carr Supply Company <small>Information in this drawing is provided for reference only.</small>	PART NUMBER <b>6357K43</b>
	Ultra-Corrosion-Resistant Mounted Ball Bearing

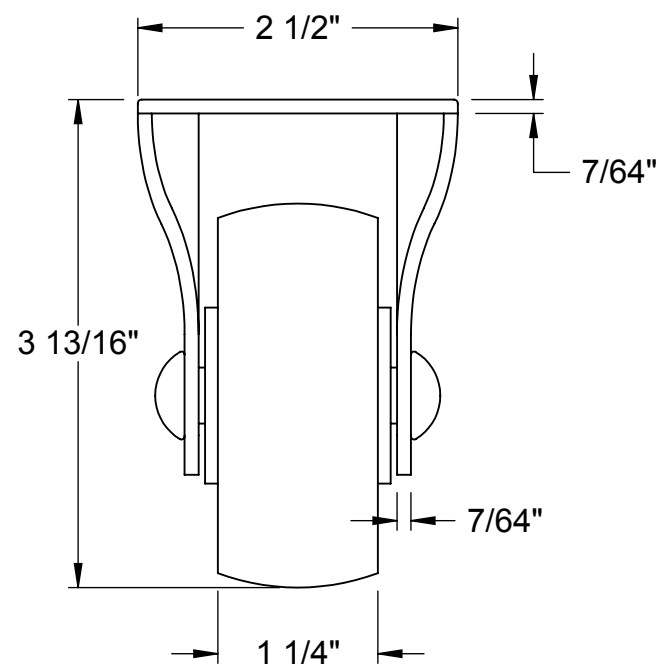
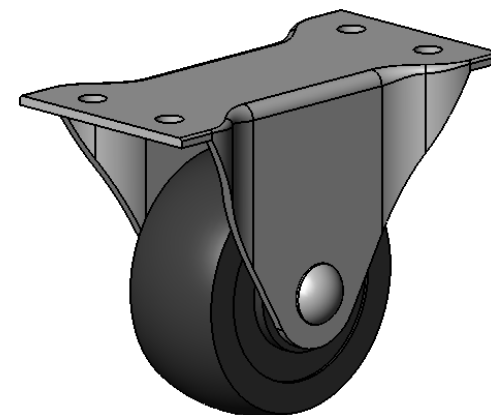
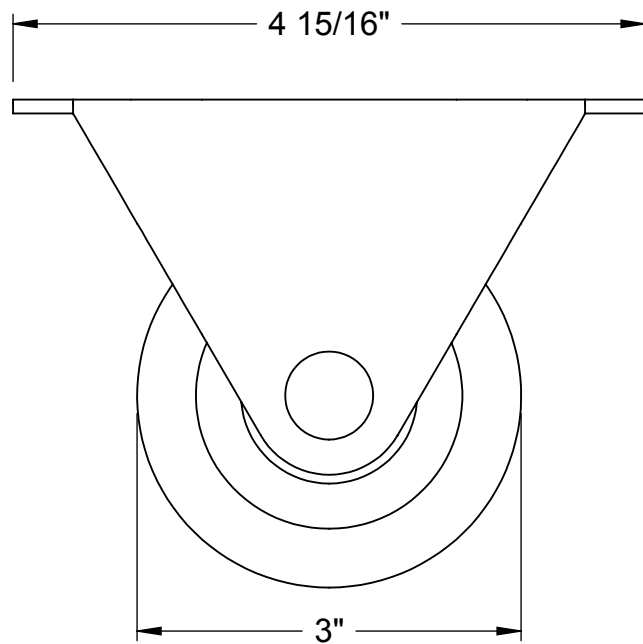
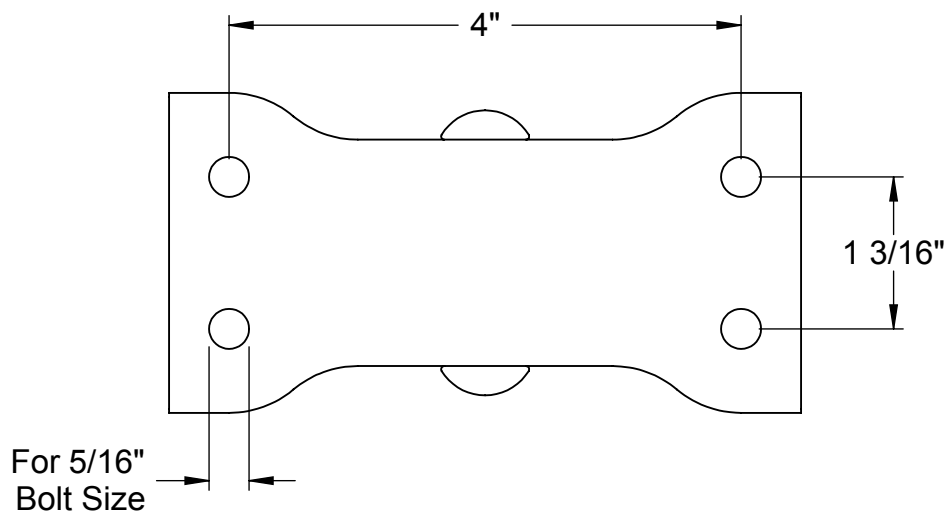

**McMASTER-CARR** CAD

<http://www.mcmaster.com>  
© 2019 McMaster-Carr Supply Company

Information in this drawing is provided for reference only.

PART  
NUMBER

**2407T64**

Cart-Smart  
Rigid Caster

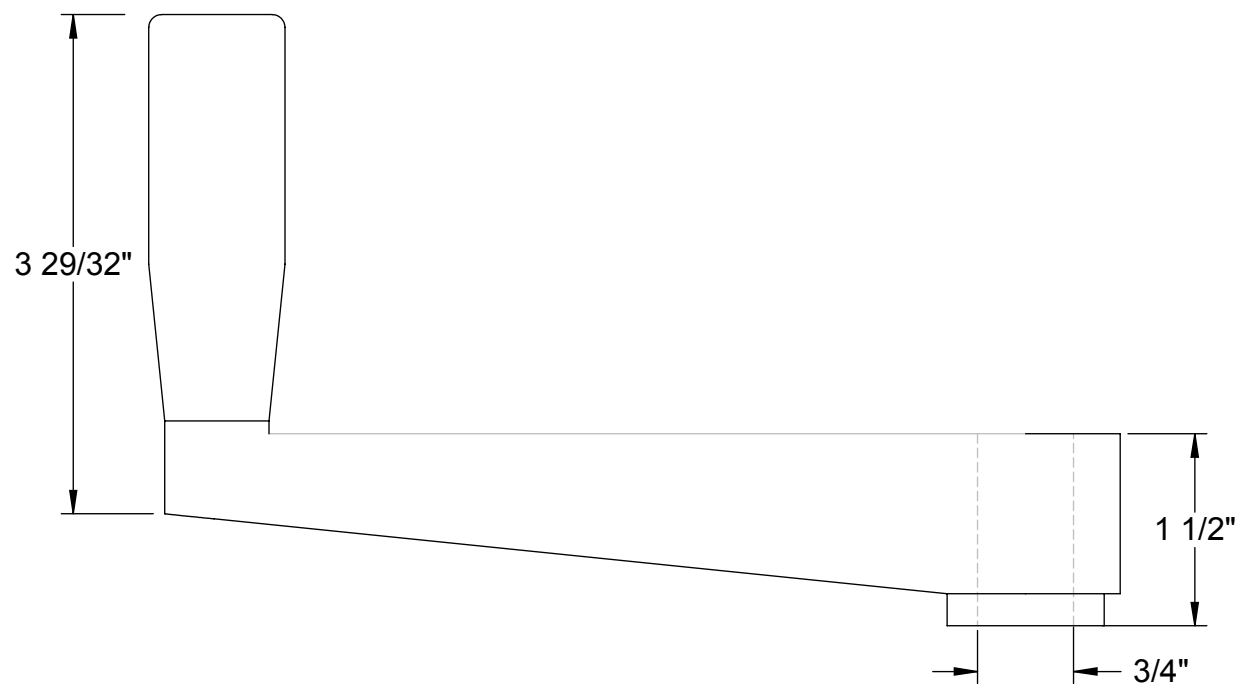
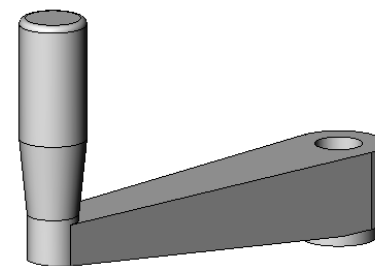
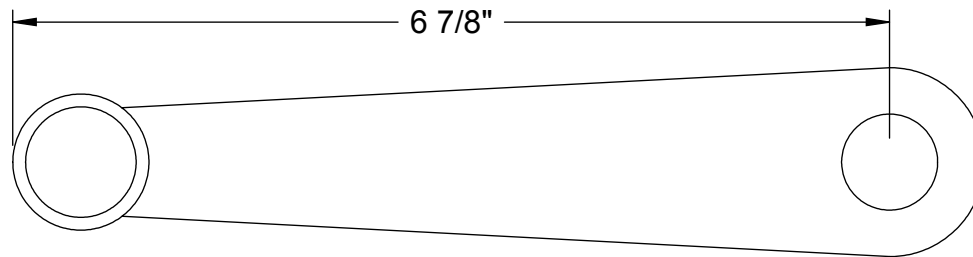

<b>McMASTER-CARR</b> <small>CAD</small> <a href="http://www.mcmaster.com">http://www.mcmaster.com</a> © 2016 McMaster-Carr Supply Company <small>Information in this drawing is provided for reference only.</small>	PART NUMBER <b>6473K55</b>
	Aluminum Crank Handle

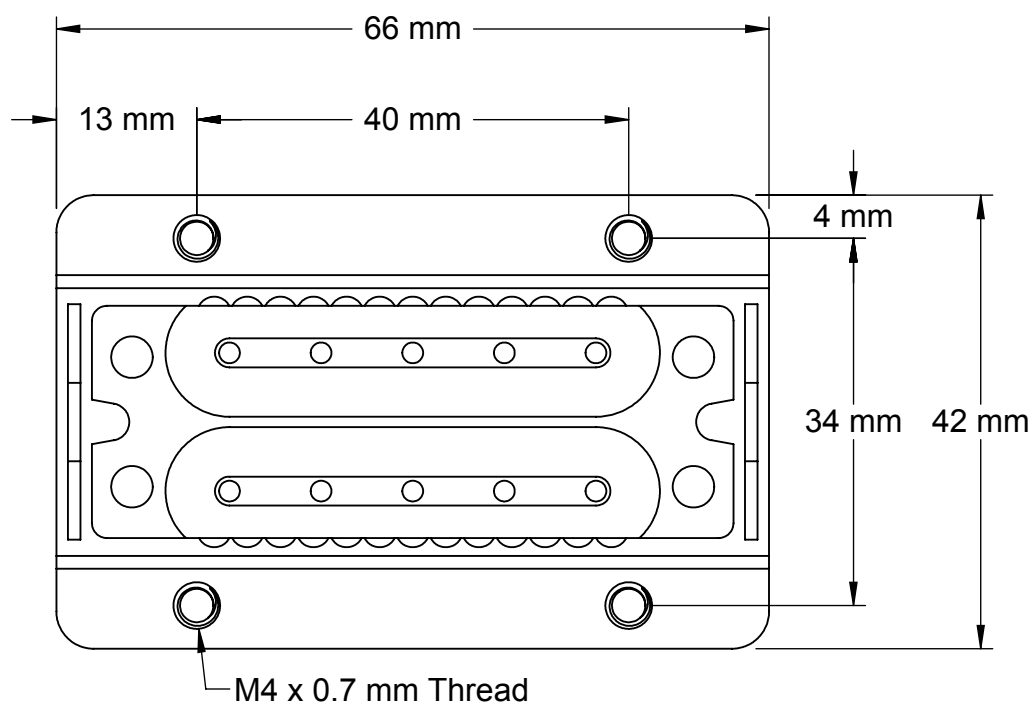
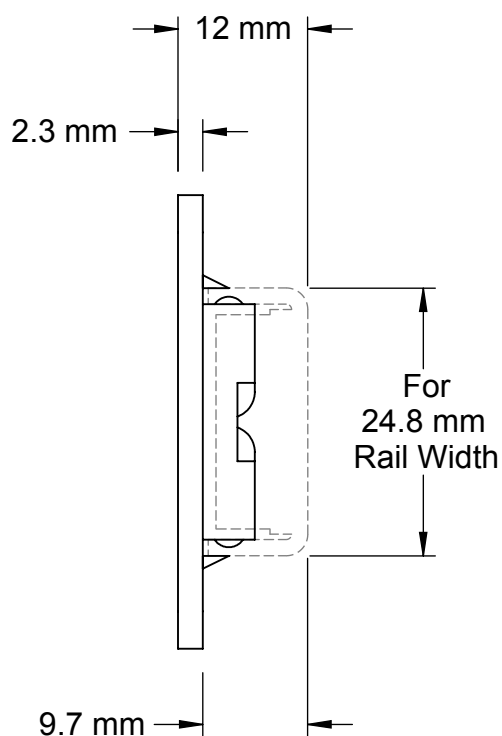
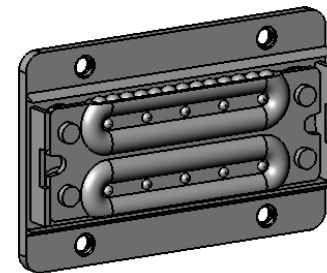

<b>McMASTER-CARR</b> <small>CAD</small> <a href="http://www.mcmaster.com">http://www.mcmaster.com</a> © 2017 McMaster-Carr Supply Company <small>Information in this drawing is provided for reference only.</small>	PART NUMBER <b>6004K13</b>
	Side-Mount Ball Bearing Carriage

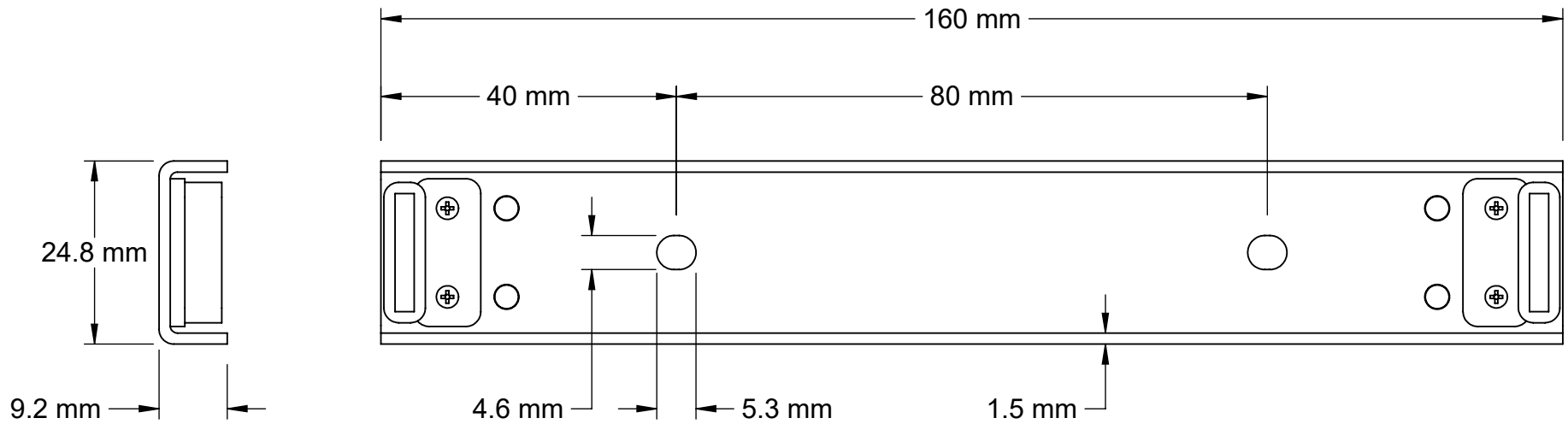

**McMASTER-CARR** CAD

<http://www.mcmaster.com>  
© 2020 McMaster-Carr Supply Company

Information in this drawing is provided for reference only.

PART  
NUMBER

**6004K61**

Guide Rails for Side-Mount  
Ball Bearing Carriages



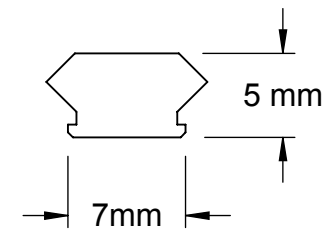
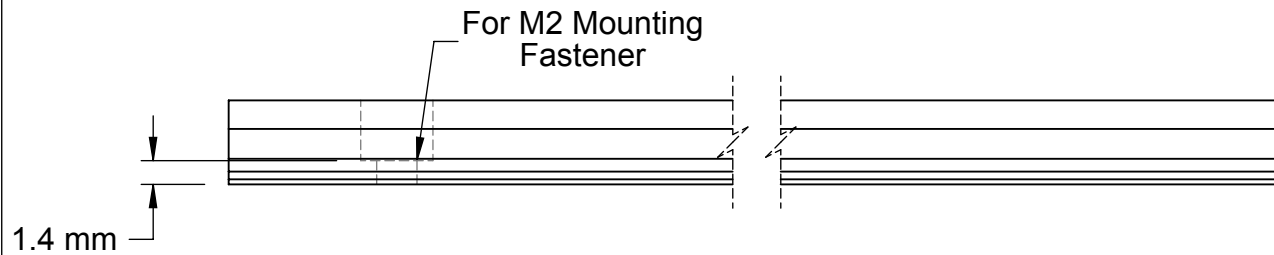
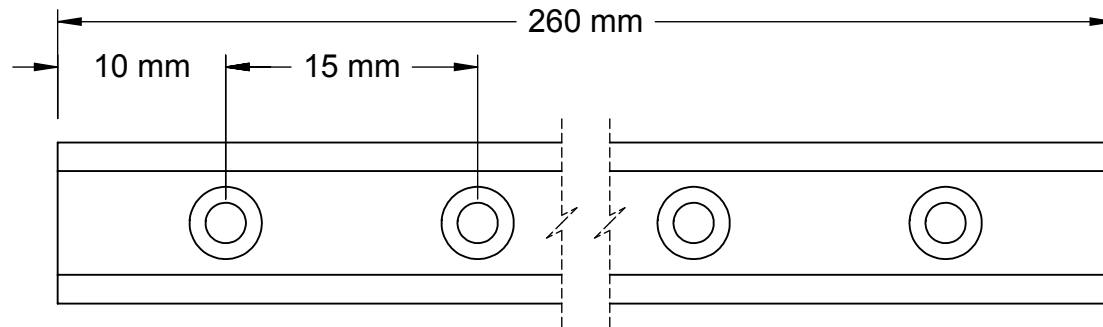
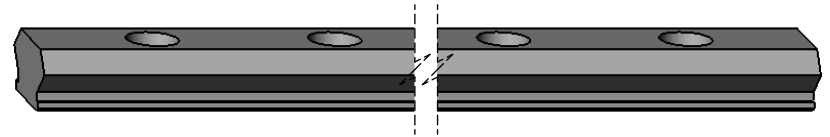

**McMASTER-CARR** CAD

<http://www.mcmaster.com>  
© 2017 McMaster-Carr Supply Company

Information in this drawing is provided for reference only.

PART  
NUMBER

**9829K113**

Sleeve Bearing  
Guide Rail

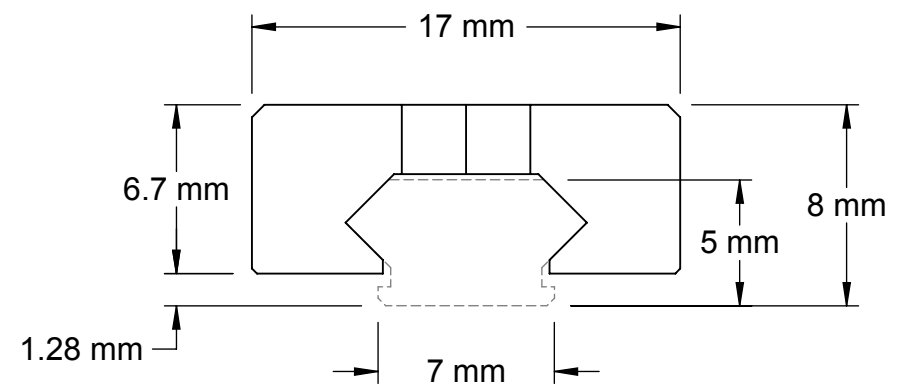
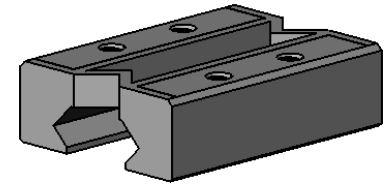
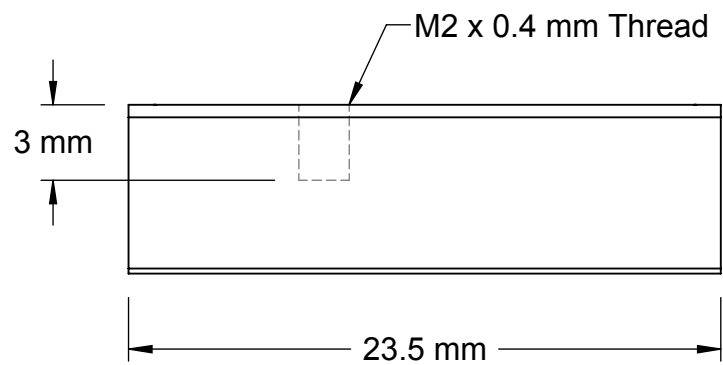
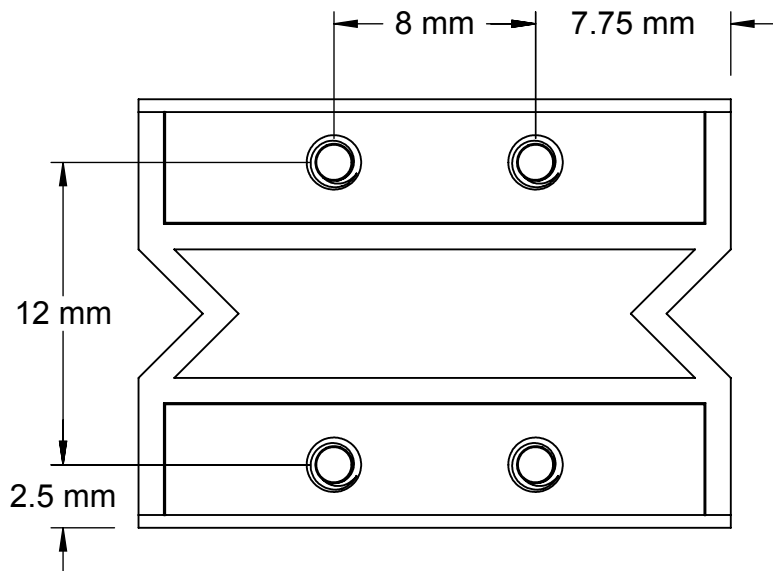

**McMASTER-CARR** CAD

<http://www.mcmaster.com>  
© 2017 McMaster-Carr Supply Company

Information in this drawing is provided for reference only.

PART  
NUMBER

**9829K1**

Sleeve Bearing  
Carriage

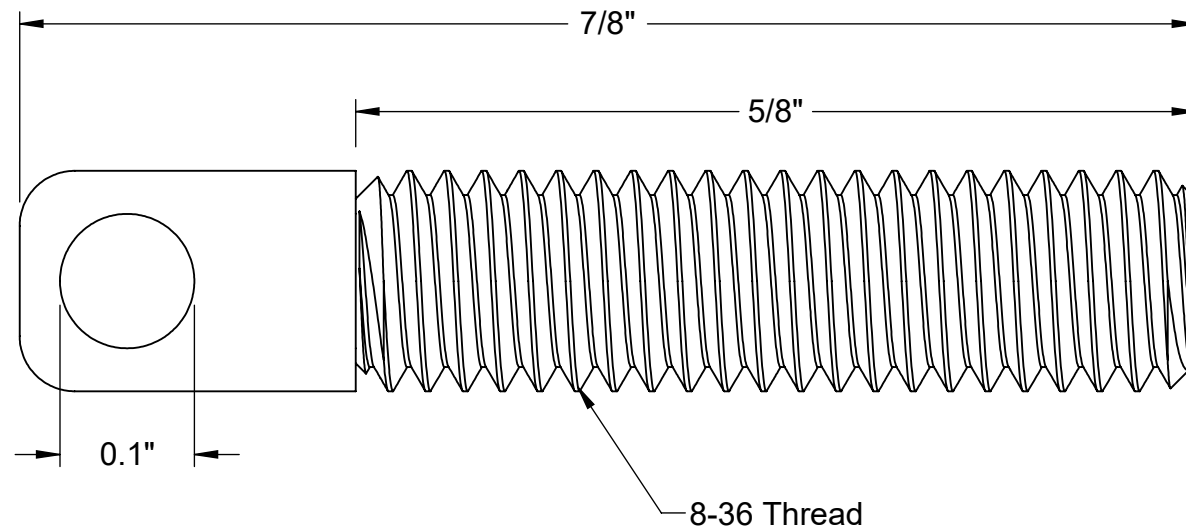
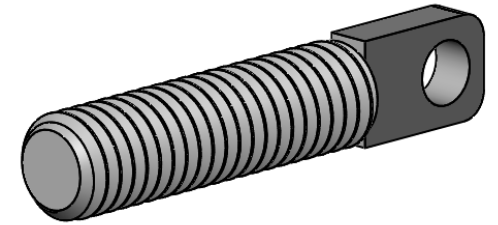

<b>McMASTER-CARR</b> <small>CAD</small> <a href="http://www.mcmaster.com">http://www.mcmaster.com</a> © 2019 McMaster-Carr Supply Company <small>Information in this drawing is provided for reference only.</small>	PART NUMBER <b>95907A110</b>
	Corrosion-Resistant Extension Spring Stud Anchor

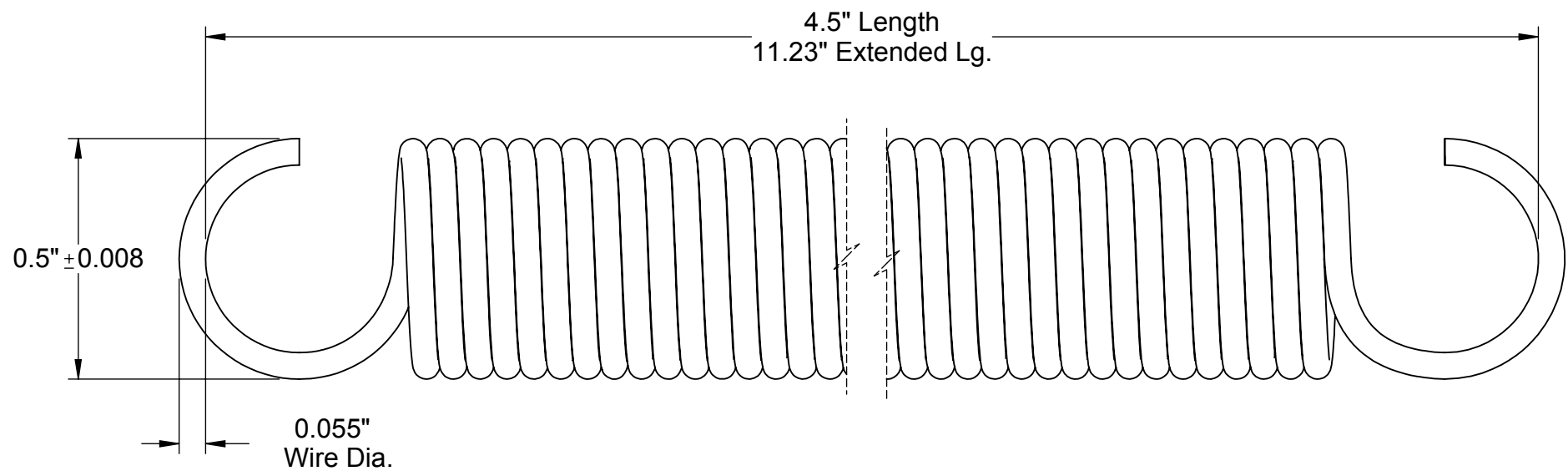
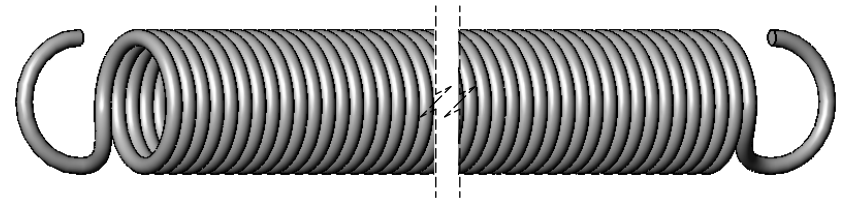

<b>McMASTER-CARR</b> <small>CAD</small>	PART NUMBER	<b>9432K73</b>
<a href="http://www.mcmaster.com">http://www.mcmaster.com</a> © 2019 McMaster-Carr Supply Company Information in this drawing is provided for reference only.		Extension Spring

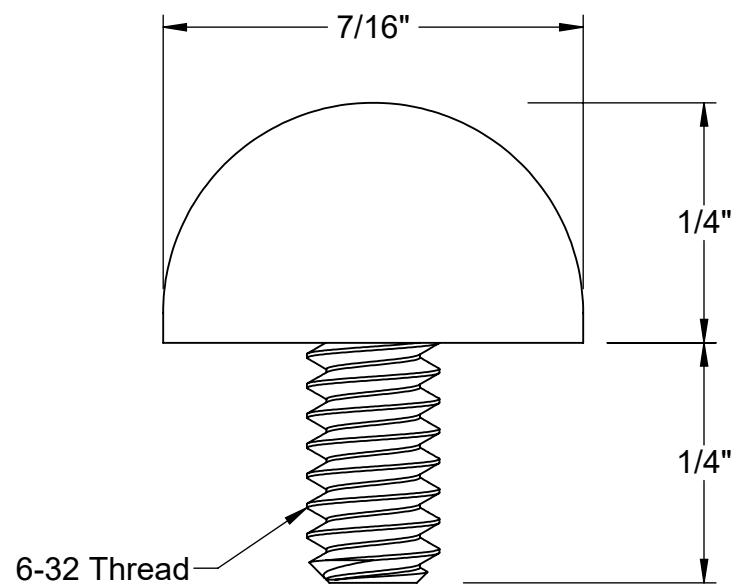
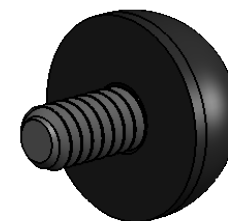

**McMASTER-CARR** CAD

<http://www.mcmaster.com>

© 2020 McMaster-Carr Supply Company

Information in this drawing is provided for reference only.

PART  
NUMBER

**9541K8**

Bumper with  
Threaded Stud

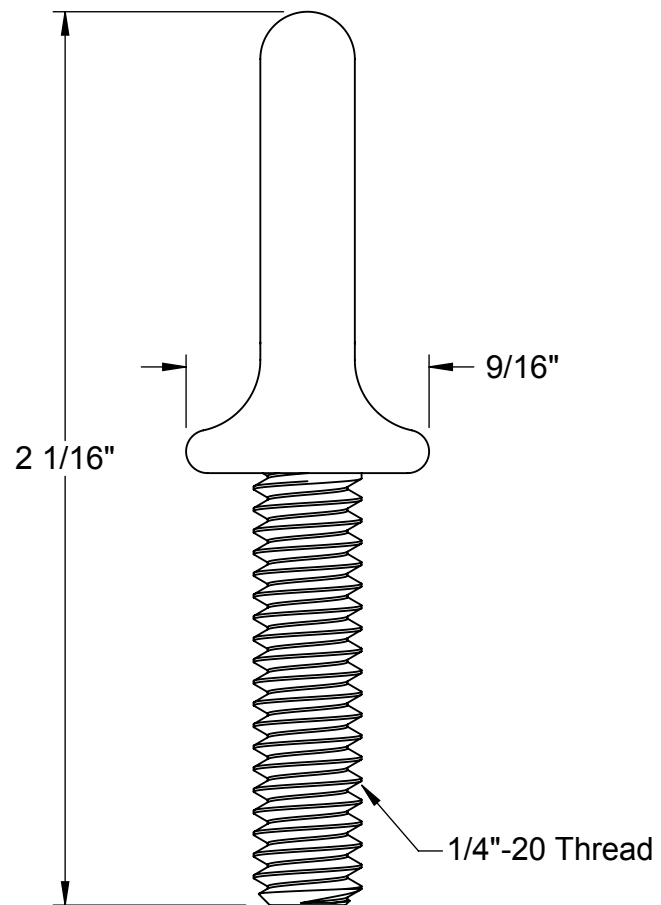
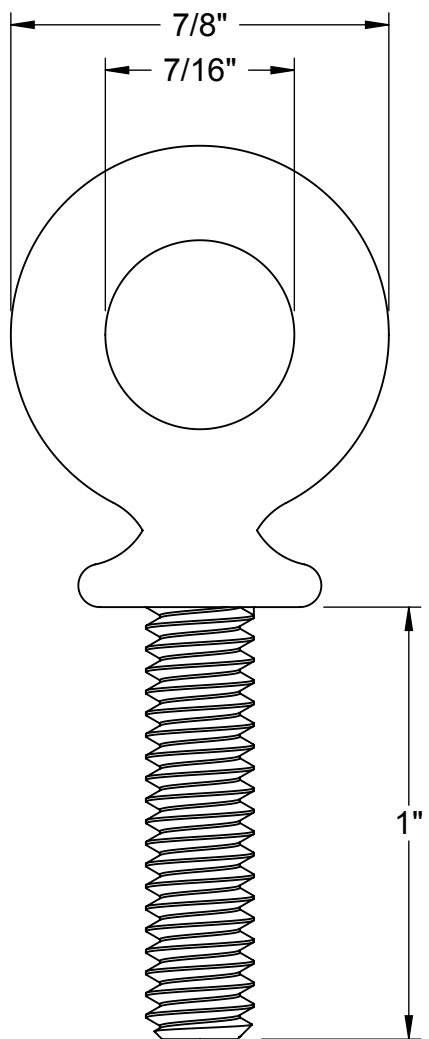

**McMASTER-CARR** CAD

<http://www.mcmaster.com>

© 2014 McMaster-Carr Supply Company

Information in this drawing is provided for reference only.

PART  
NUMBER

**30295T22**

Corrosion-Resistant Fiberglass  
Routing Eyebolt -Not for Lifting

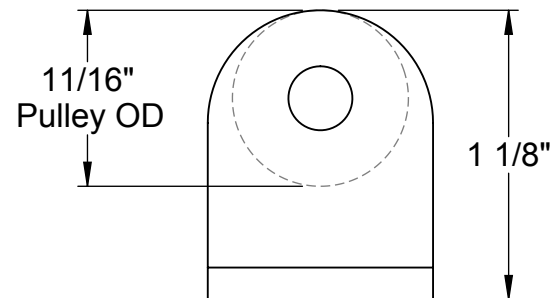
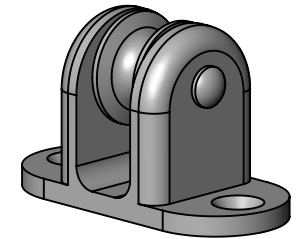
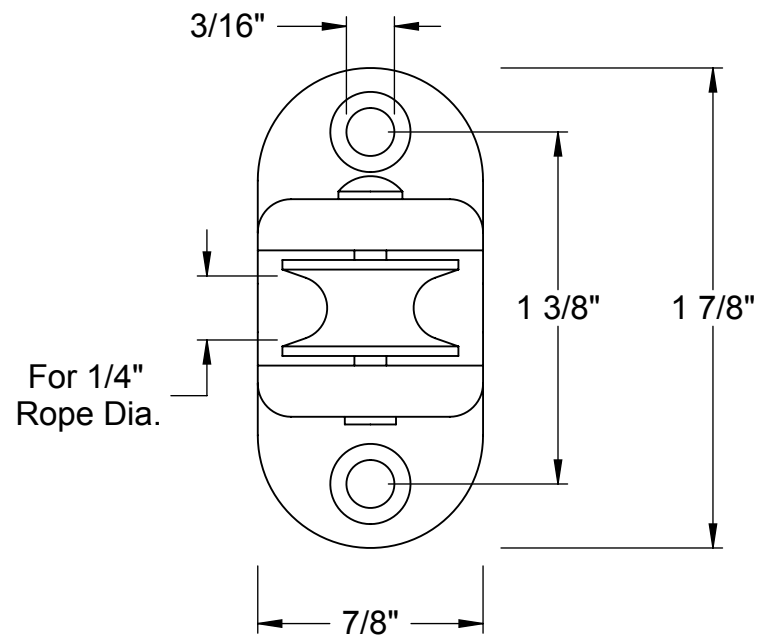

**McMASTER-CARR** CAD

<http://www.mcmaster.com>  
© 2013 McMaster-Carr Supply Company

Information in this drawing is provided for reference only.

PART  
NUMBER

**3071T7**

Mounted Pulley for  
Fibrous Rope