

# CM Computer Lab Revised Design

With PDF markup tools such as Bluebeam and 3D modeling programs such as Revit and ArchiCAD becoming important parts of the Construction Management curriculum our CM computer lab has become an important room in building 186. However, with three or more sections of the CM 280 - Building Information Modeling (BIM) class and other labs reserving the computers weekly and a need to continuously improve the BIM class to stay current with industry technology trends, our computer lab can not currently satisfy all users. The goal of this project was to determine student and department needs of the computer lab and use feedback to guide a revised design of the lab.

**Matt Williamson - Cal Poly SLO - Spring 2019**



The floor plan of the revised CM Computer Lab design

# Student Rankings and Feedback

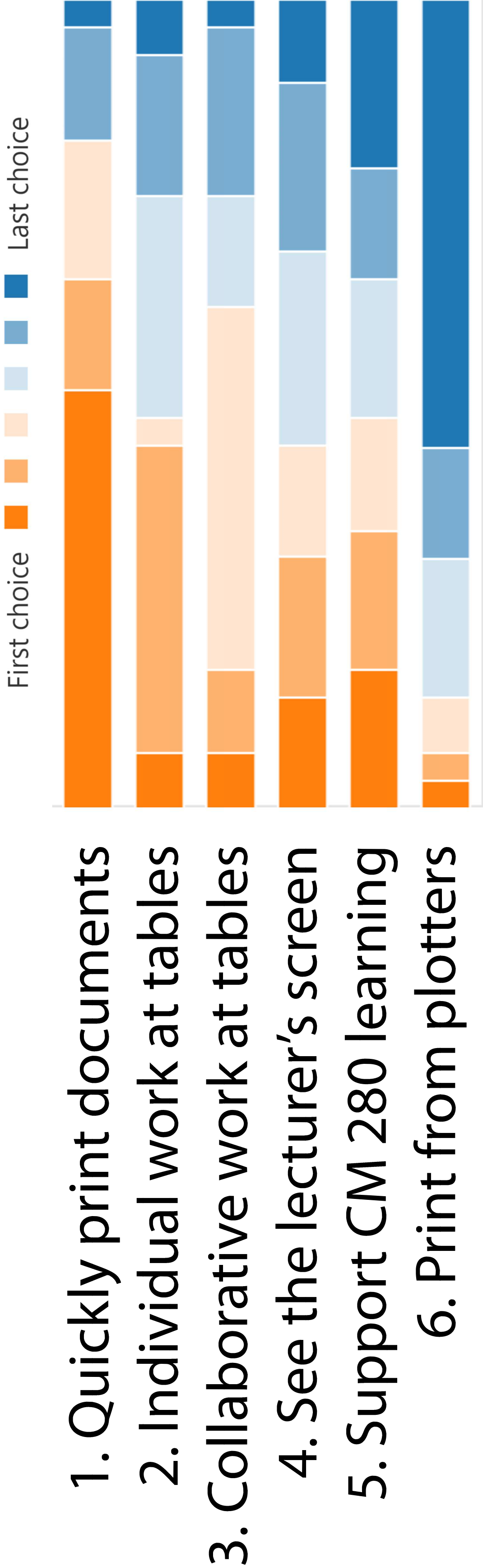

1 = not effective, 3 = neutral, 5 = extremely effective

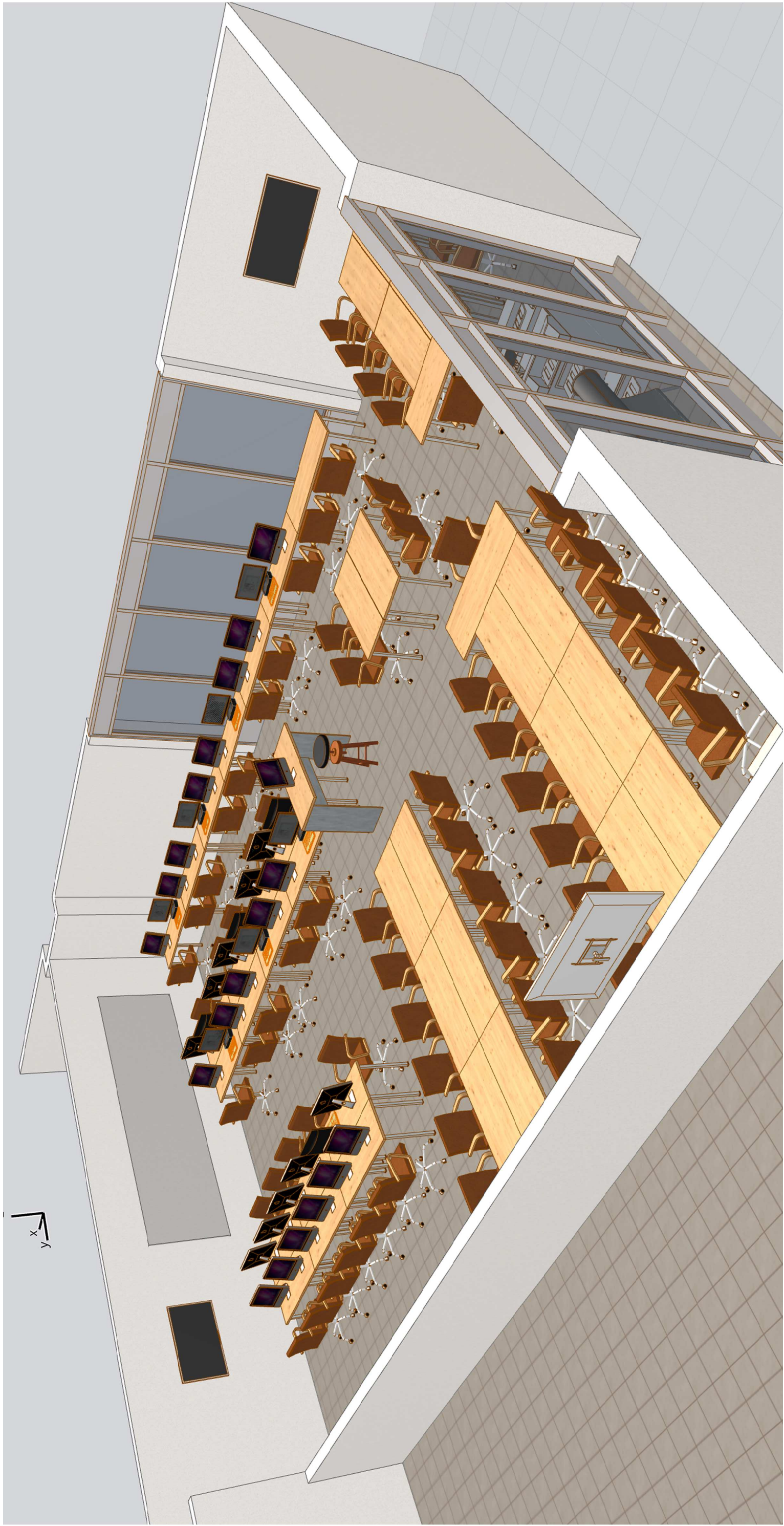
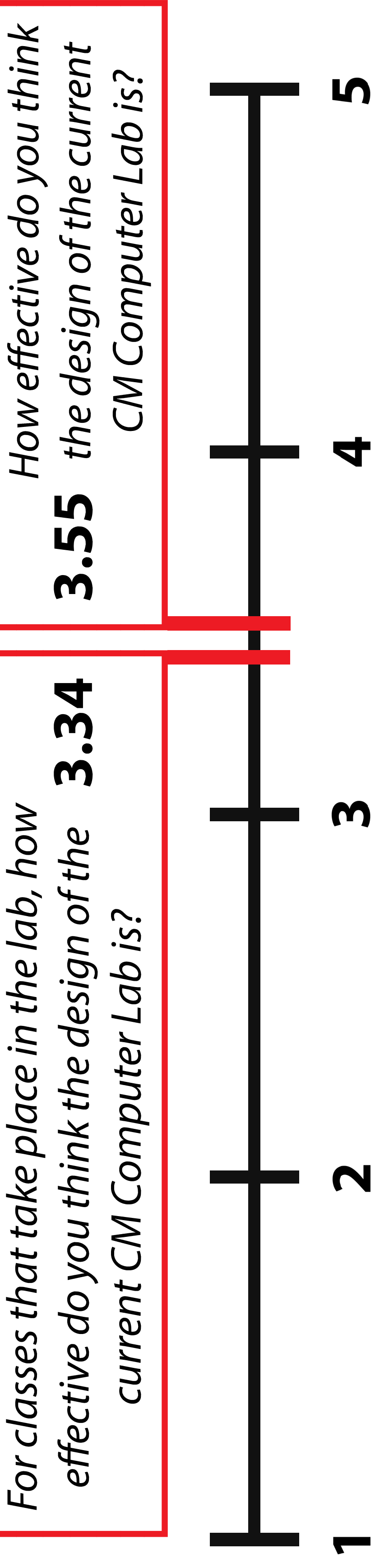

A 3D rendering of the revised CM Computer Lab design