



Karambo River Master Plan



Design Description:

Size: 11,400 SF

Duration: 9.5 Months

Cost: \$416,000 USD or \$36.50 / SF

Materials: Confined Masonry, Steel Trusses

Project Team:



Shea Menzel, Architect



Stella Bates, ARCE



Sophia Abshire, ARCE



Nick Somera, CM

Abstract:

My senior project consisted of an interdisciplinary partnership with students in the College of Architecture & Environmental Design and the non-profit, Journeyman International. My project team has been given the Karambo River Master Plan located in Rwanda, Africa. Empowering Villages, the sponsor for the project, has bought land to make way for new buildings in a fairly remote area with no existing utilities. The site, near the Mahoko village, will foster community, learning, and growing together. There will be a library, classroom, and multi-purpose building constructed for the surround villages in the area. Empowering Villages has also partnered with Afritech Energy to provide a hydropower plant that will provide power to the village and make it more sustainable. The purpose of my project is to develop, prepare, and submit a preconstruction package for Journeyman International. My main deliverables as the construction manager include a full conceptual estimate with quantity take offs and a complete project schedule. Other deliverables include research to provide a feasibility analysis, hazard and risk mitigation plan, storm water pollution prevention plan, site safety plan, and a phasing plan.

Keywords:

Rwanda, Humanitarian Construction, International Construction, Confined Masonry, Non Profit

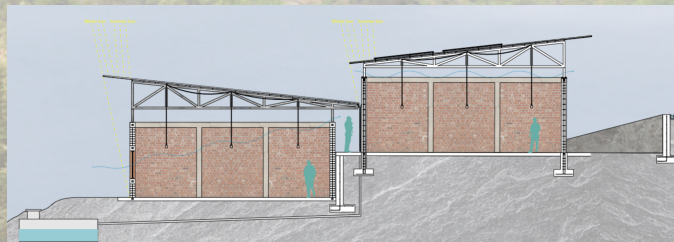

Nick Somera
JI Humanitarian Designer
nicks@journeymaninternational.org
(209) 747-1456