



Journeyman International – Malawi City Cottage

Stefan Denny, Construction Management Undergraduate
California Polytechnic State University San Luis Obispo



Abstract

This report details the partnership between Journeyman International and City Cottage, to design and construct an educational facility near Lilongwe, Malawi. Journeyman International is a non-profit humanitarian design and construction organization with the mission of connecting top tier CAED students from around the nation to collaborate on philanthropic efforts in the form of senior projects. The proposed project is a 5,800 sqft educational facility built on an institutional land grant; designed to house an auditorium and additional classroom space. The project utilized rammed earth construction methods with steel reinforcement. This report's focus is on the construction management process of this project, and the deliverables that went along with it.

Key Words: Malawi, International Construction, Rammed Earth, Humanitarian, Education, City Cottage

Deliverables

- QTO
- Estimate
- Schedule
- Phasing Map
- Site Plans
- Utilization, SWPPP & Safety Plans

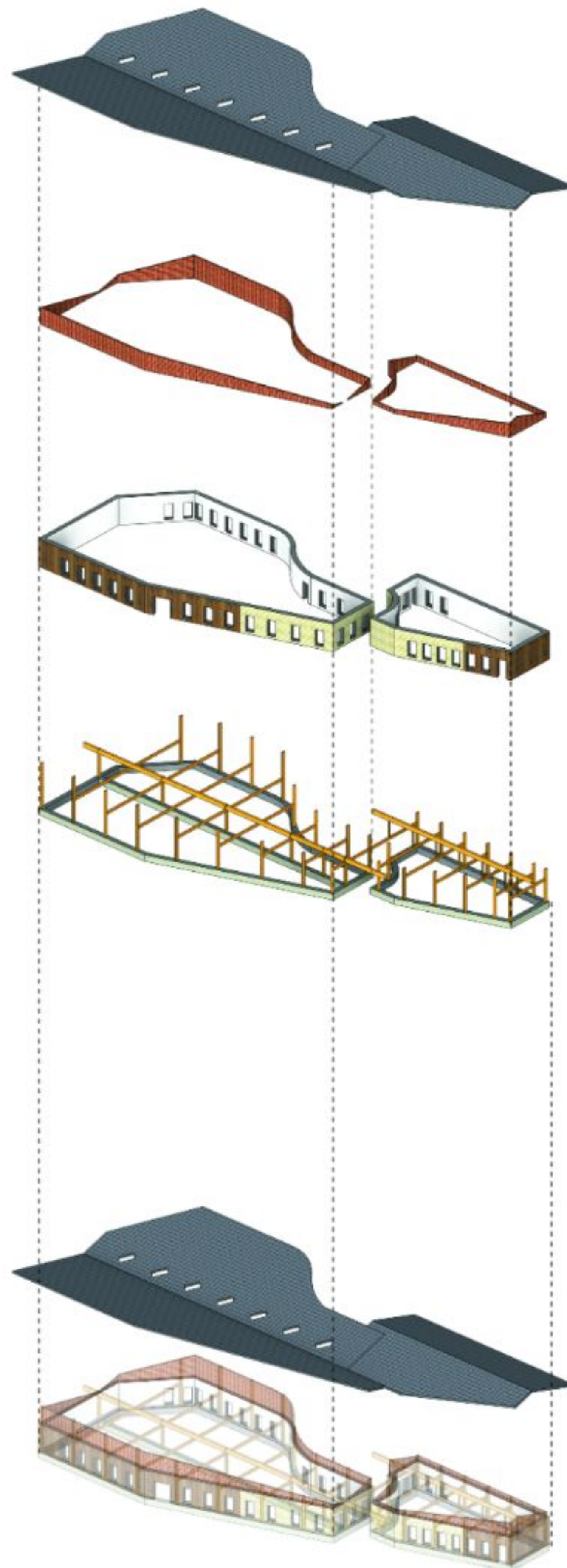

Project Overview

Project Quick Facts

Location: Lilongwe, Malawi
Client: City Cottage
Size: 5,794 Sq Ft
Budget: 284,000 USD
Target \$/SF: 43.25

Collaborating Entities:
Journeyman International



Brief Narrative:

The project is the brainchild of humanitarian relief worker, Luke Dolby and architect Xianlong Zheng. Initially designed for an alternate JI project in South Africa, the concept was adopted for the Malawi City Cottage project in 2017.



Stefan Denny, JI Humanitarian Designer
stefan@journeymaninternational.org
stdenny@calpoly.edu